

Raleigh Studios – Final MPD Submittal



Raleigh Studios – List of Updated Plans/Images

- 1 Page 03 – Updated Site Context
- 2 Page 09 – Updated Conceptual Site Plan
- 3 Page 23 – Note to see Conceptual Grading Plan for Berm Plan



Raleigh Studios – Context

Healthcare Campus

Quinns Rec Complex

National Ability Center

Proposed Film Studio

Park City Heights



Raleigh Studios – Connectivity (Roads)

Healthcare Campus

Quinns Rec Complex

National Ability Center

Proposed Film Studio

Park City Heights



Raleigh Studios – Connectivity (Trails)

Healthcare Campus

Quinns Rec Complex

National Ability Center

Proposed Film Studio

Park City Heights



Raleigh Studios – Conceptual Site Plan

Conceptual Site Plan
03/14/2012 Planning Commission



Raleigh Studios – Conceptual Site Plan Revisions



Conceptual Site Plan
03/28/2012 Planning Commission

Raleigh Studios – Conceptual Site Plan Revisions

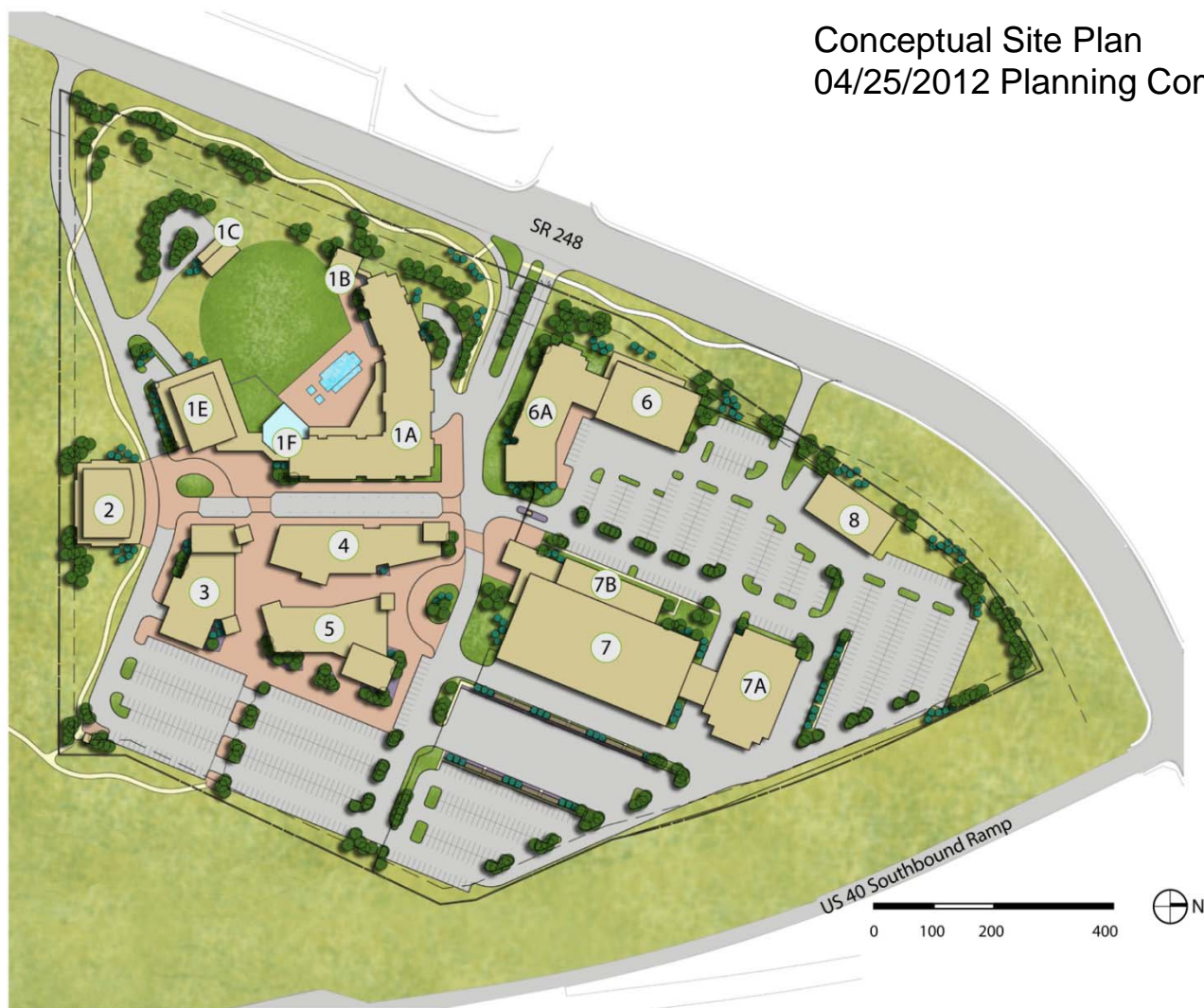

Raleigh Studios – Conceptual Site Plan

Conceptual Site Plan w/ SR-248 access changes

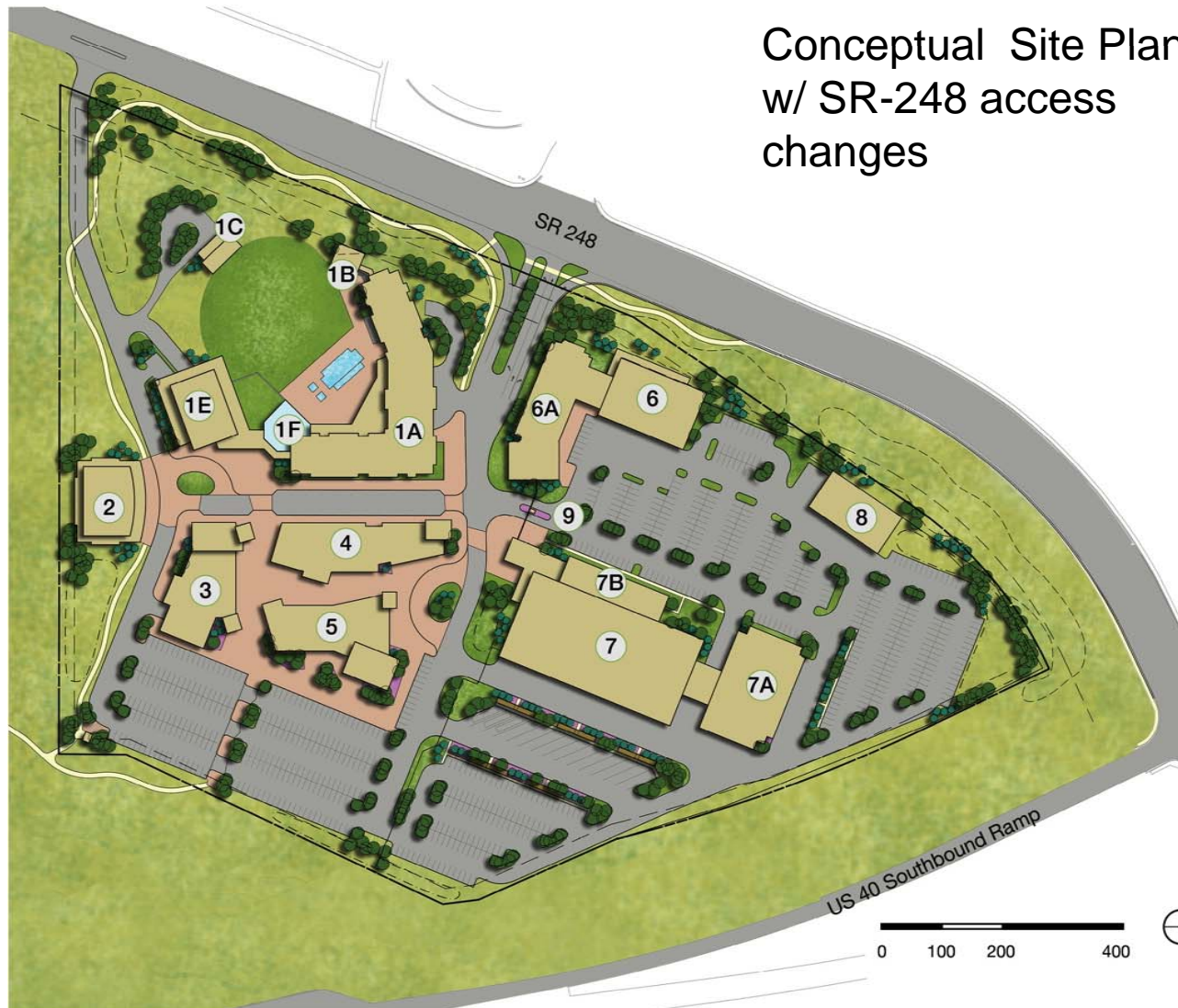

Building Legend

- 1A Hotel Lodging
- 1B Recording Studio
- 1C Stage Venue
- 1D Residence - omitted
- 1E Grand Ball Room
- 1F Atrium
- 2 Screening Rooms/Theater
- 3 Entertainment Venue
- 4 Mixed Use
- 5 Mixed Use
- 6 Sound Effects Stage
- 6A Office, Effects Stage
- 7 Sound Stages
- 7A Workshop
- 7B Production Support/ Offices
- 8 Workshop Office
- 9 Guard House

Raleigh Studios – Building Heights/Sizes



Bldg #	Bldg Use	Sqft (Gross)	Building Hts (Ft)
1A	Hotel Lodging (100 Keys)	112,000	40'
1B	Recording studio	2,500	16'
1C	Stage Venue	700	28'
1D	Residence (Omitted)	0	
1E	Grand Ballroom	16,000	28'
1F	Atrium	0	28'
2	Screening Rooms / Theater	15,000	40'
3	Entertainment Venue	14,500	40'
4	Mixed Use	33,350	28'
5	Mixed Use	25,625	28'
6	Sound Effects Stage	15,700	40'
6A	Office	37,200	38'
7	Sound Stages	47,375	60'
7A	Workshop	20,000	28'
7B	Production Support/ Offices	24,000	34'
8	Workshop Office	10000	18'
9	Guard House	50	10'
Total		374,000	

- Building heights and percentages comply with requirements of the Annexation Agreement
- See 3D massing for building heights

Raleigh Studios – Conceptual Site Plan

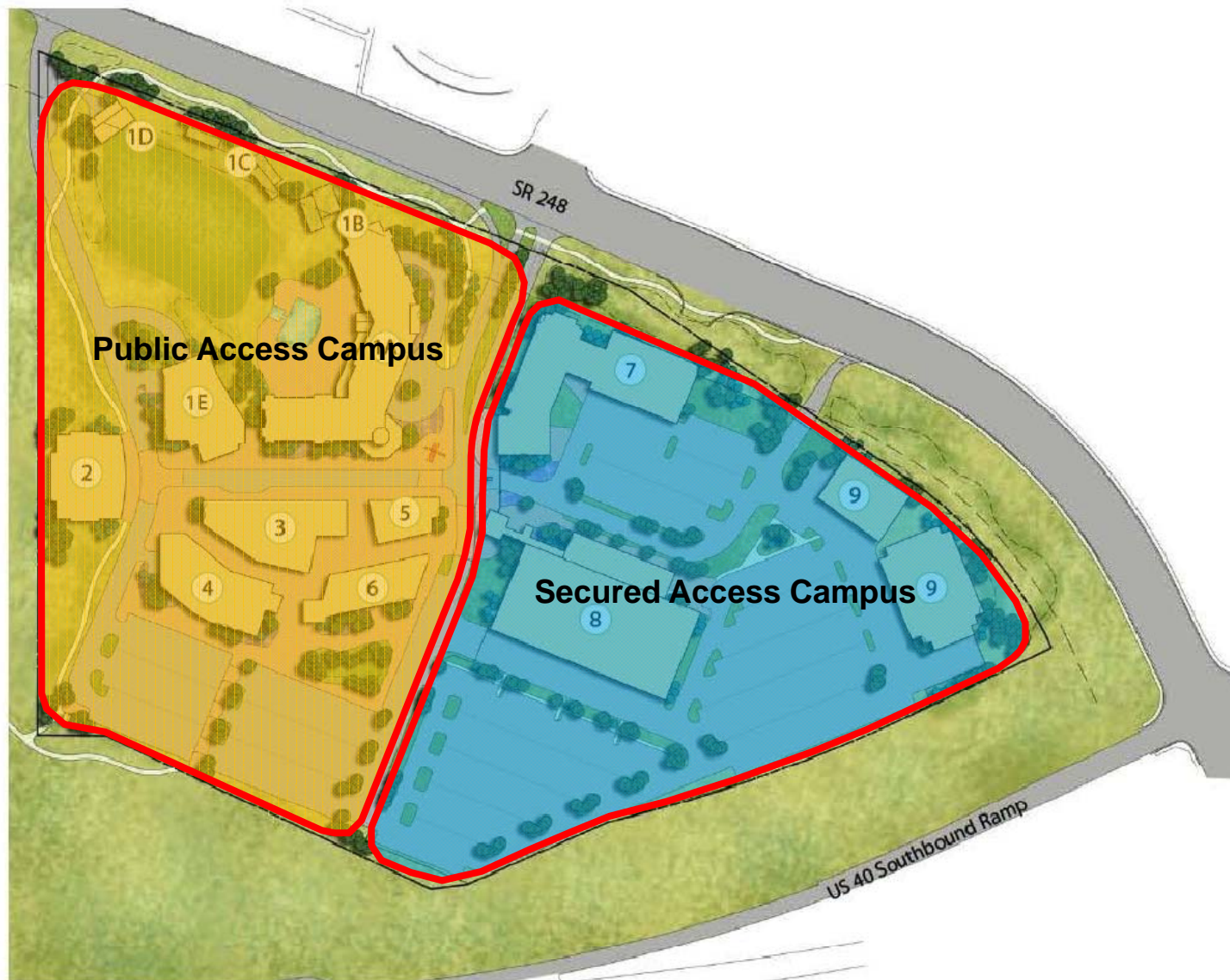

Raleigh Studios – Visual Analysis



Massing Study Looking South

Raleigh Studios – Visual Analysis



Massing Study Looking South

Raleigh Studios – Visual Analysis



Massing Study Looking SE

Raleigh Studios – Visual Analysis



Buildings 7, 7A and 7B Massing Study Looking S

Raleigh Studios – Visual Analysis



Building 7B and Entry Gate Massing Study Looking NE

Raleigh Studios – Visual Analysis



Buildings 5 and 7 Massing Study Looking NW

Raleigh Studios – Visual Analysis



View from US40 Northbound

Raleigh Studios – Building 7 Wall Section



SOUTH ELEVATION - NOT TO SCALE

CONCEPT MATERIALS

1. PRECAST CONCRETE
2. CORTEN STEEL
3. CORRUGATED STEEL
4. WOOD
5. NATURAL STONE
6. ALUMINUM CLAD
7. GLASS CURTAIN WALL
8. METAL PANEL
9. TRANSLUCENT PANELS
10. STUCCO - EFIS



WEST ELEVATION - NOT TO SCALE

Raleigh Studios – Building 7 Wall Section

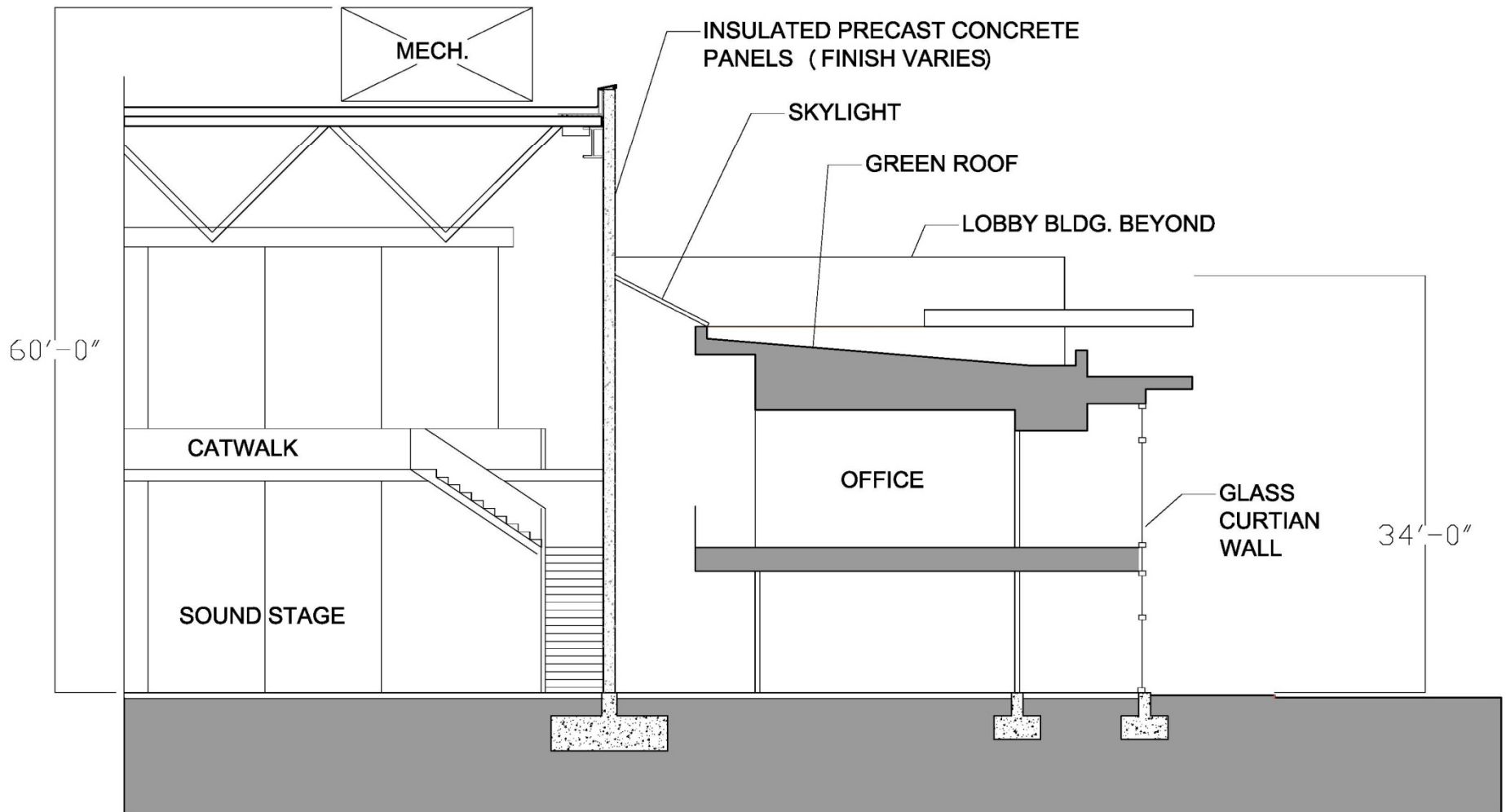

Raleigh Studios – Existing Building Overlay



Existing Buildings

- ① Hospital with Surrounding Parking

Raleigh Studios – Existing Building Overlay



Existing Buildings

- ① Hospital
- ② Ice Rink
- ③ Hotel Park City
- ④ Summit County Health
- ⑤ USSSA

Raleigh Studios – Open Space

Proposed Open Space

- 495,713 sf = 11.60 acres = 39.3% (On-Site)
- 713,077 sf = 16.60 acres = 56.2% (Top of Cut Slope)
- 841,579 sf = 19.54 acres = 66.1% (Edge of Pavement)

**See Conceptual Grading Plan for Berm Plan
Page 36*

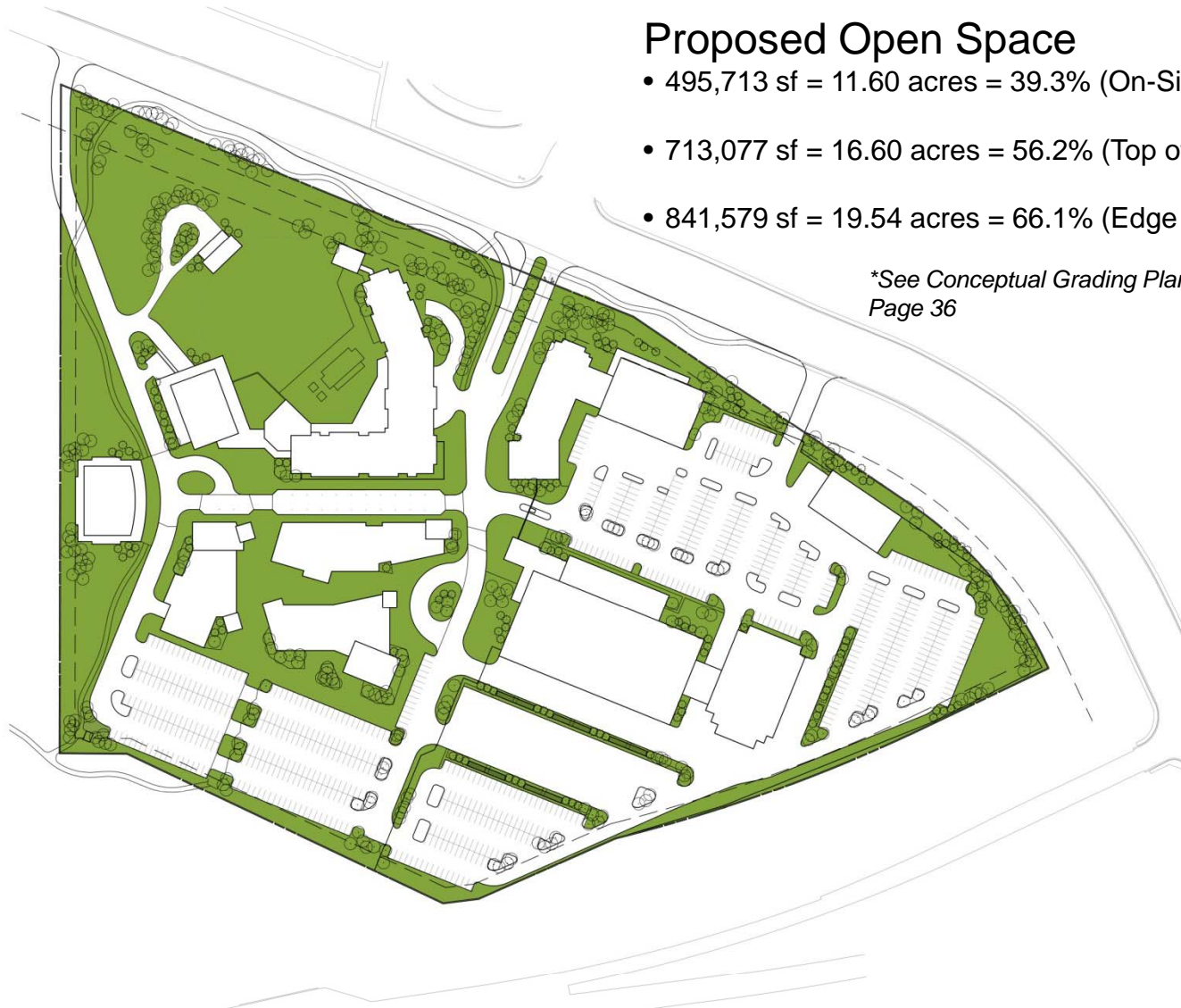

Raleigh Studios – Water/Sewer

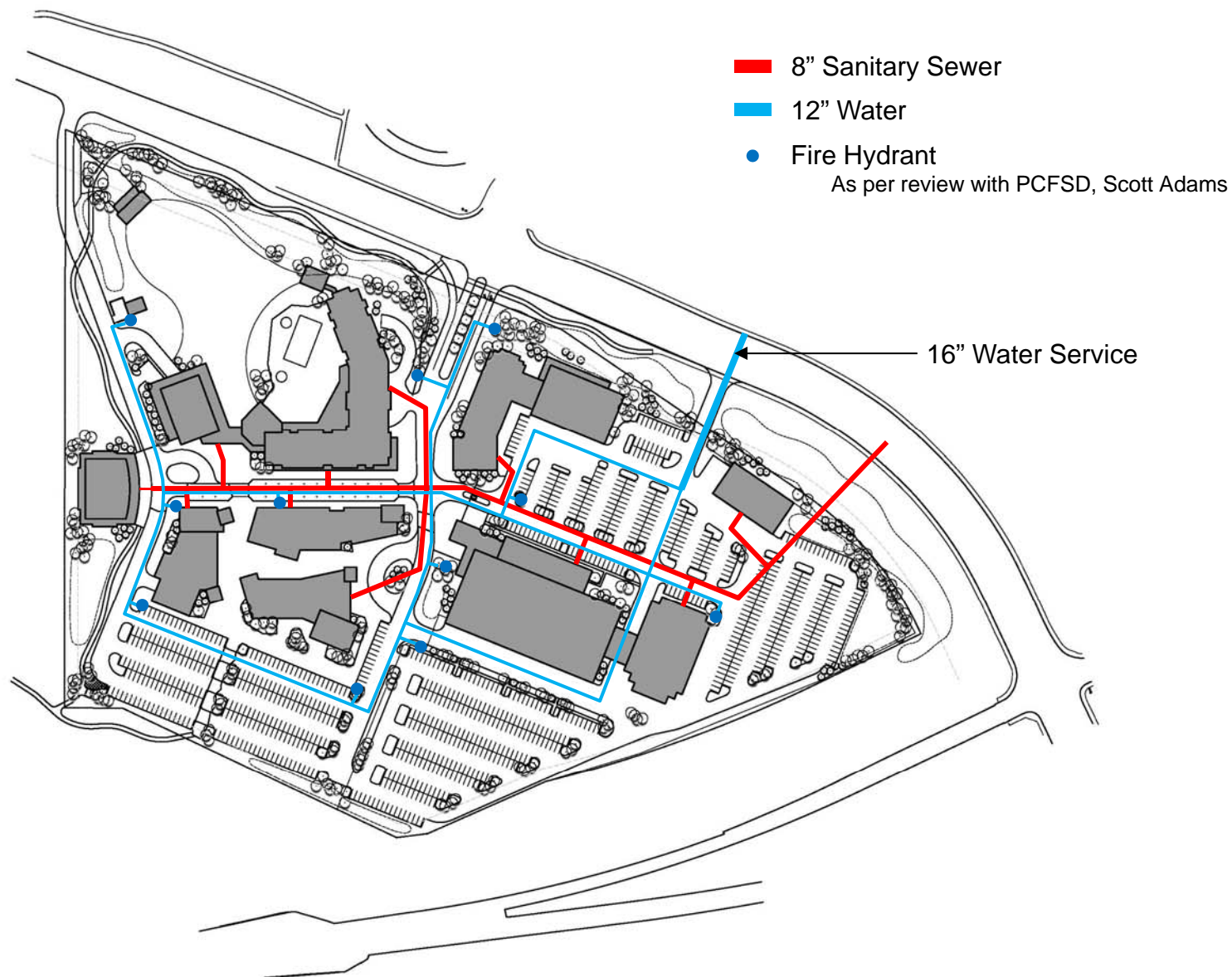

Raleigh Studios – Fire Access Routing Plan

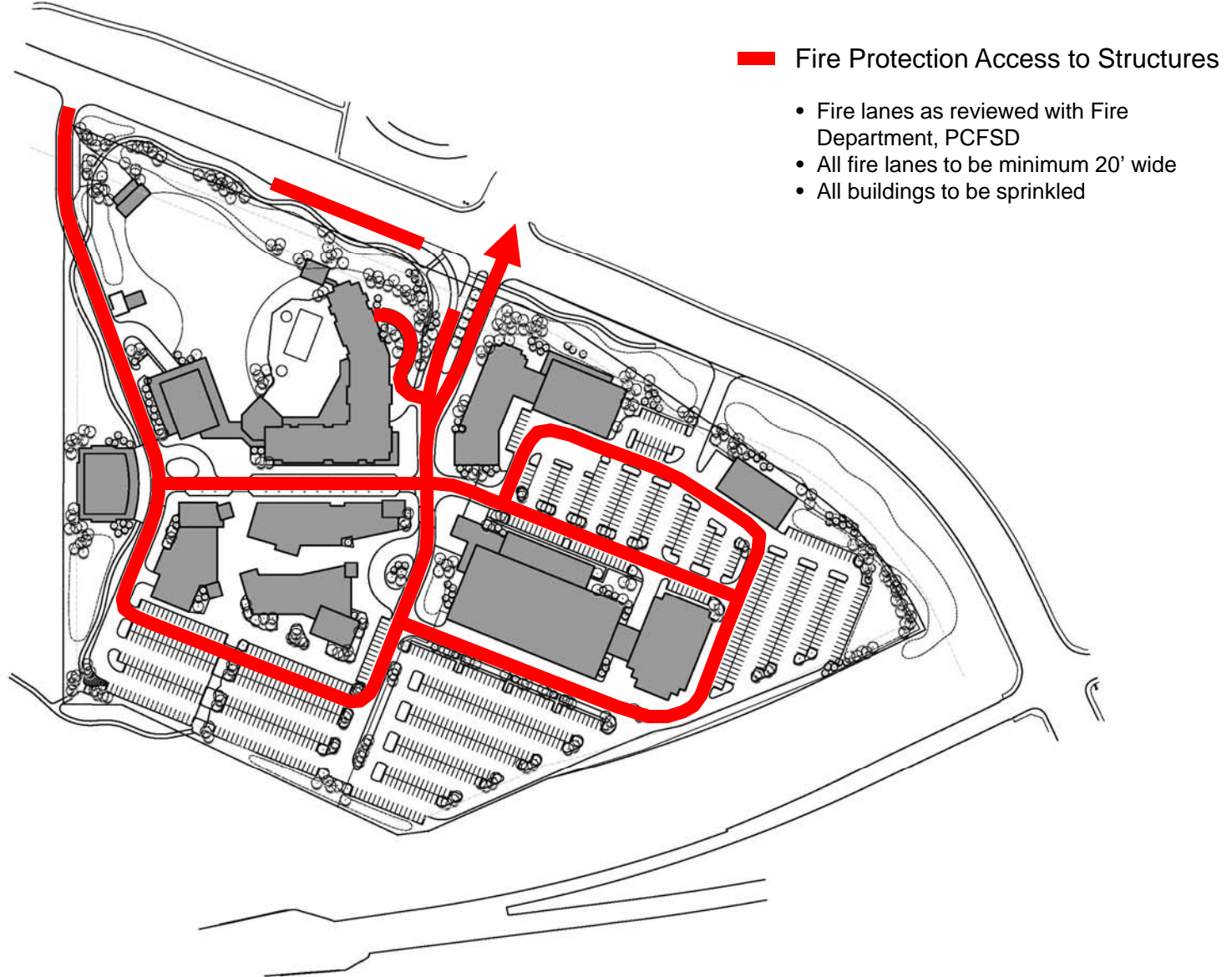

Raleigh Studios – Dry Utilities

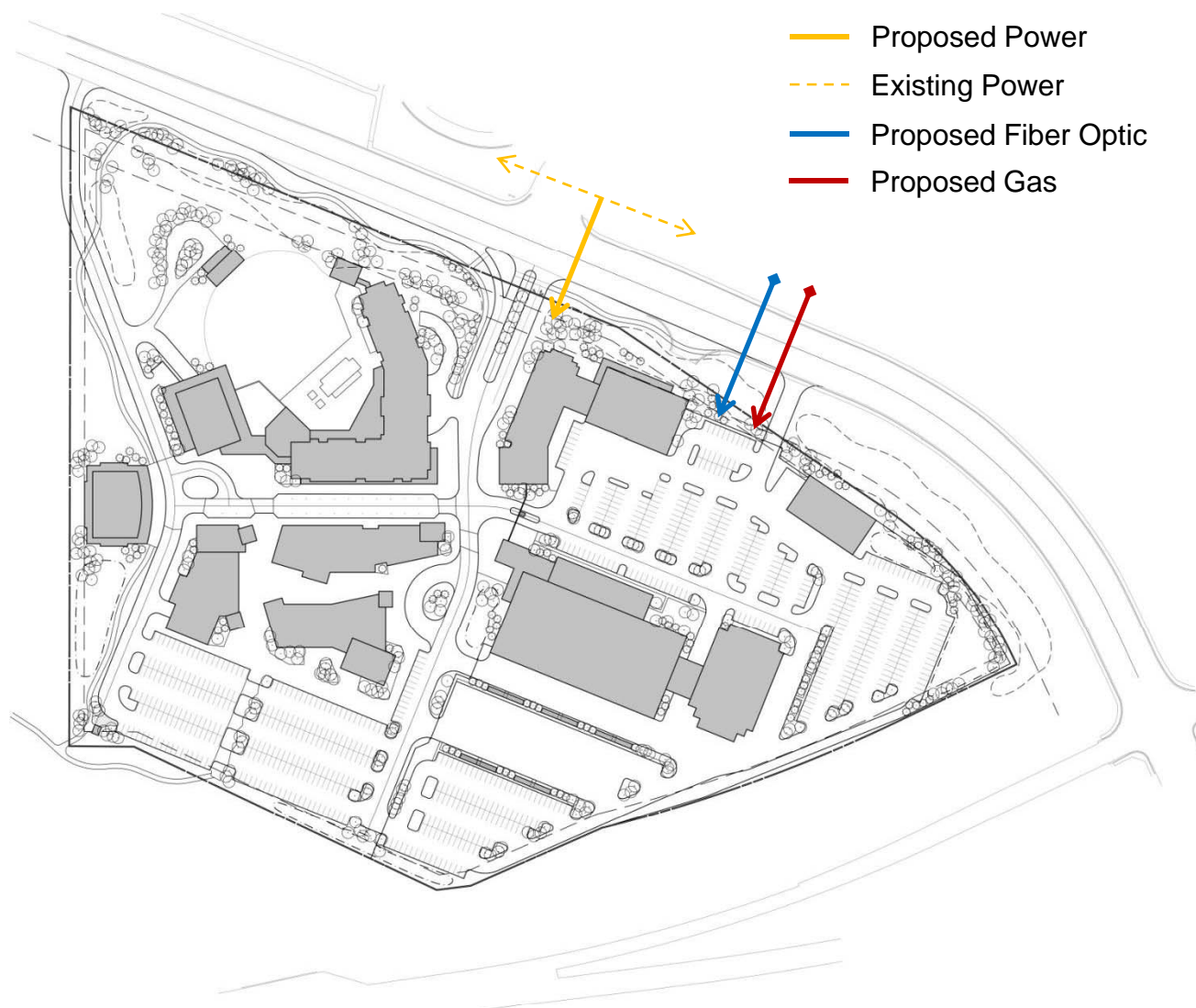

Raleigh Studios – Detention/Bioswales/Drainage

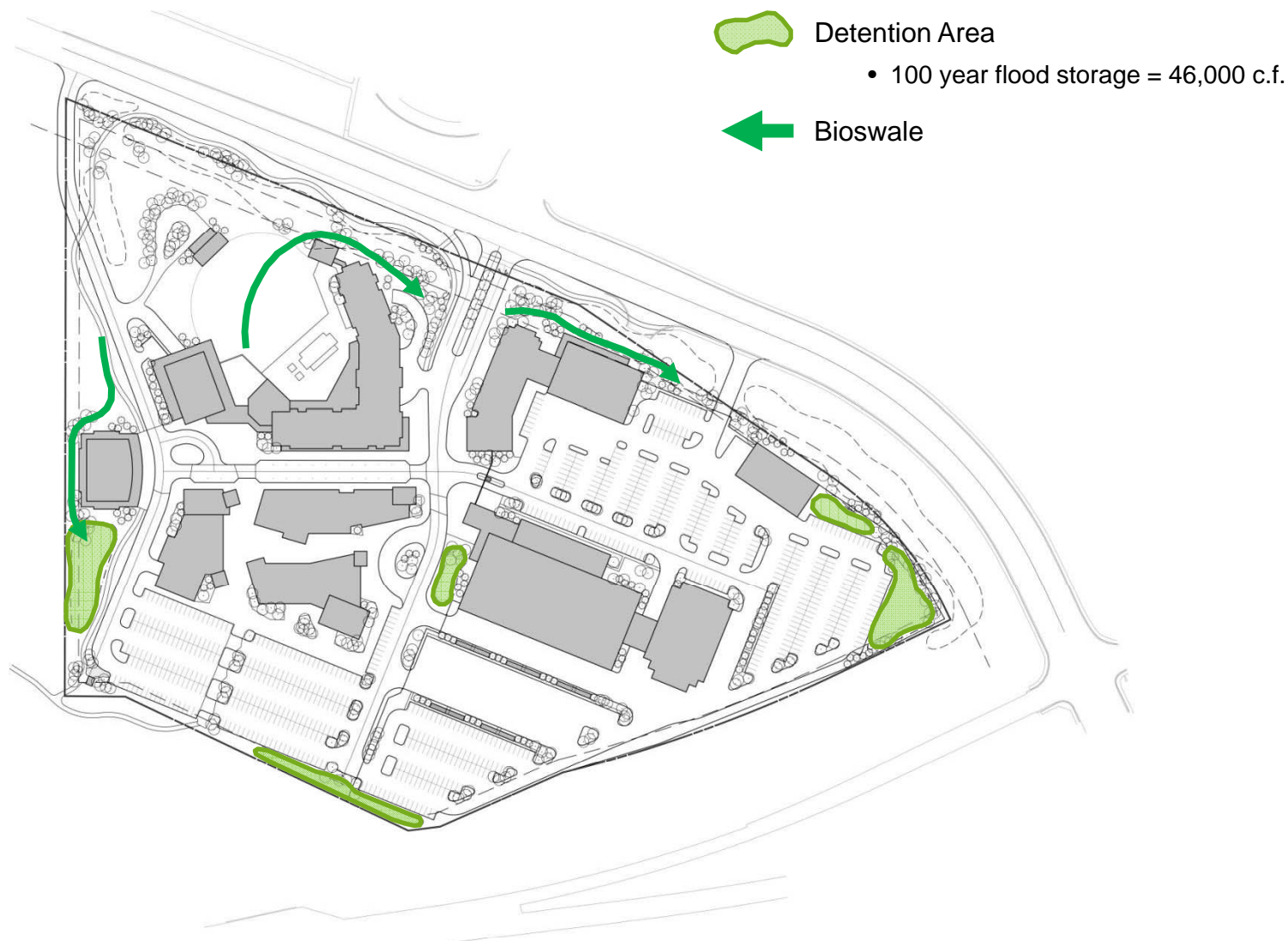

Raleigh Studios – Snow Storage Plan

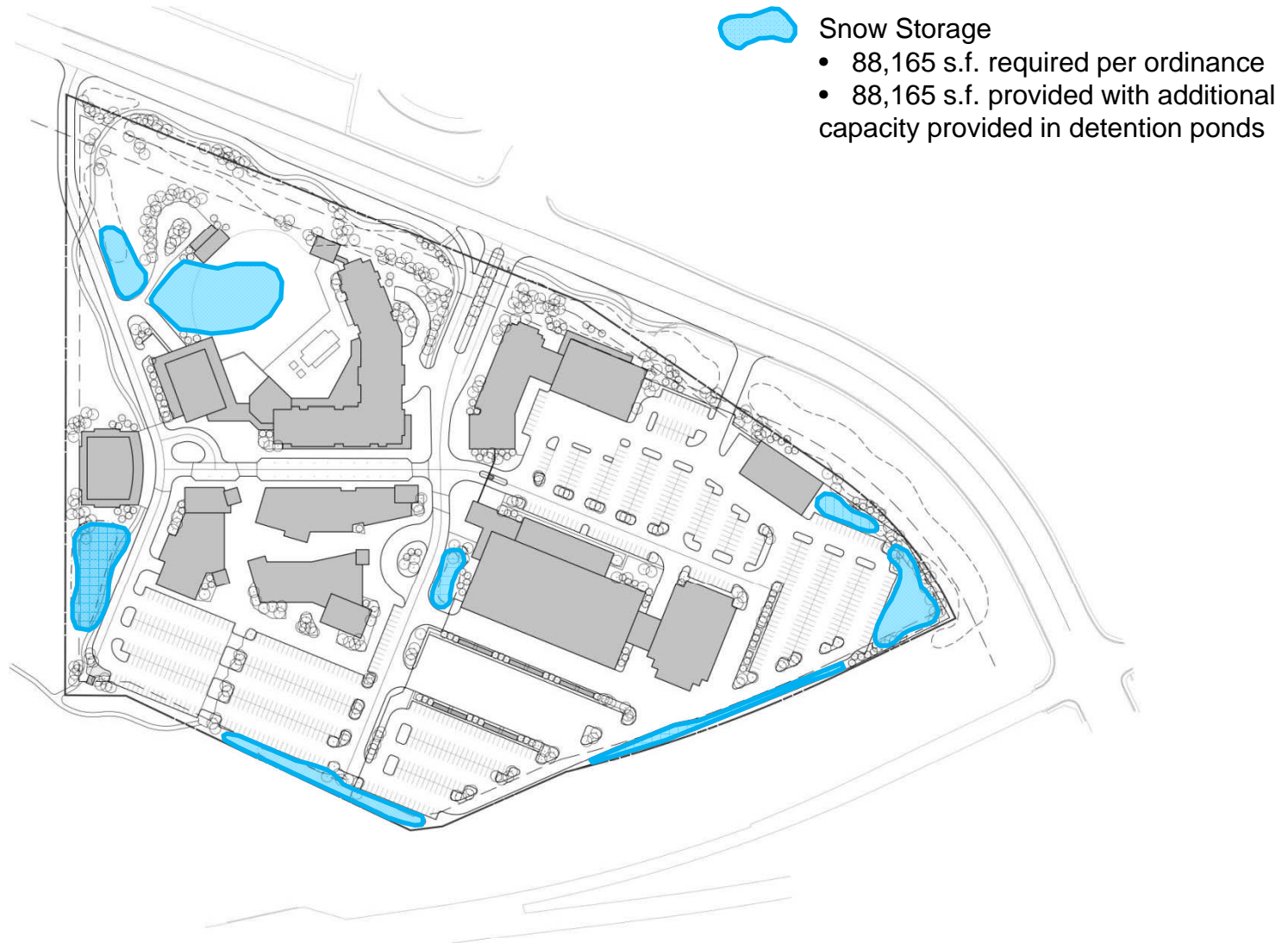

Raleigh Studios – Parking Plan w/Counts

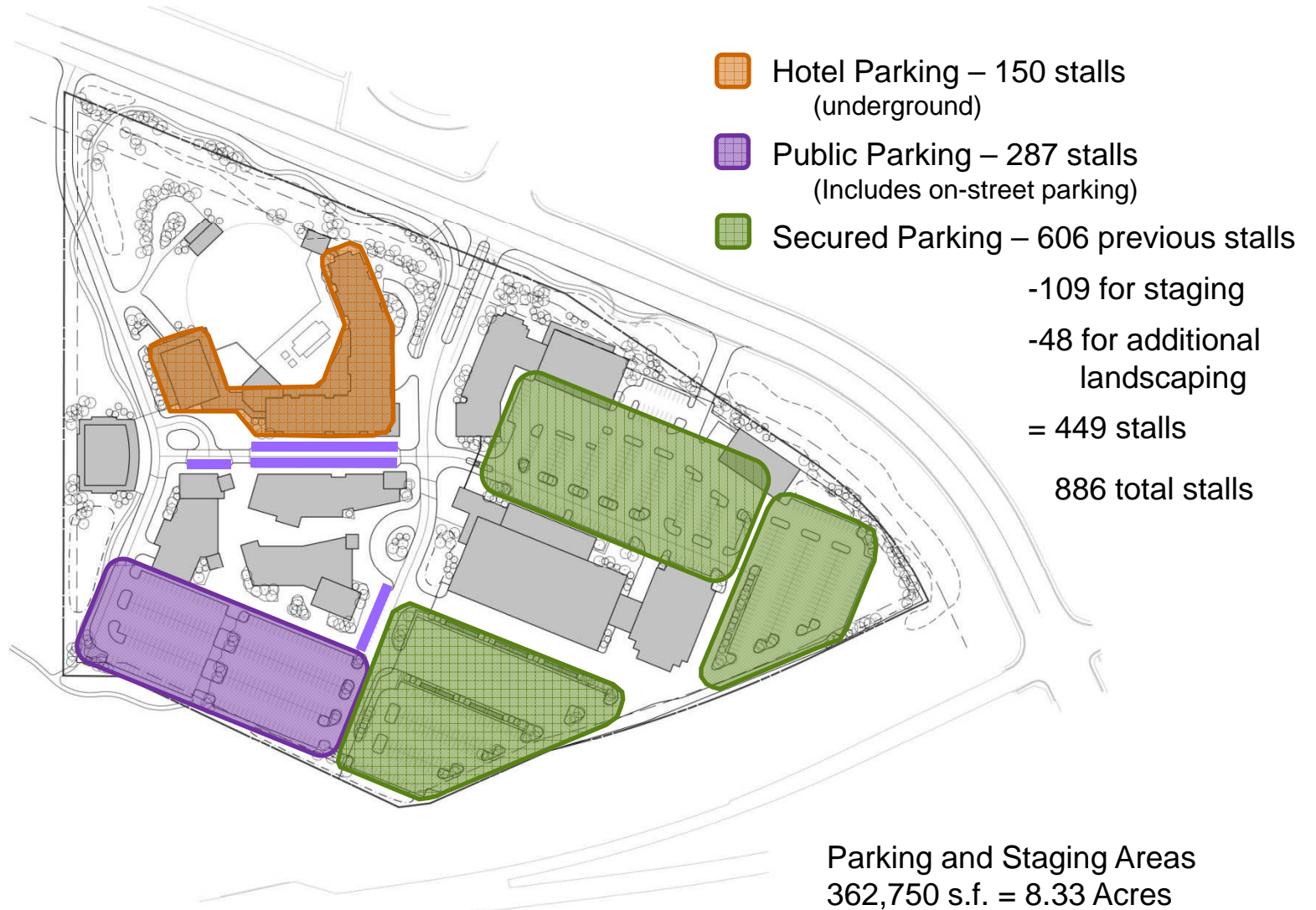

Raleigh Studios – Parking Phasing

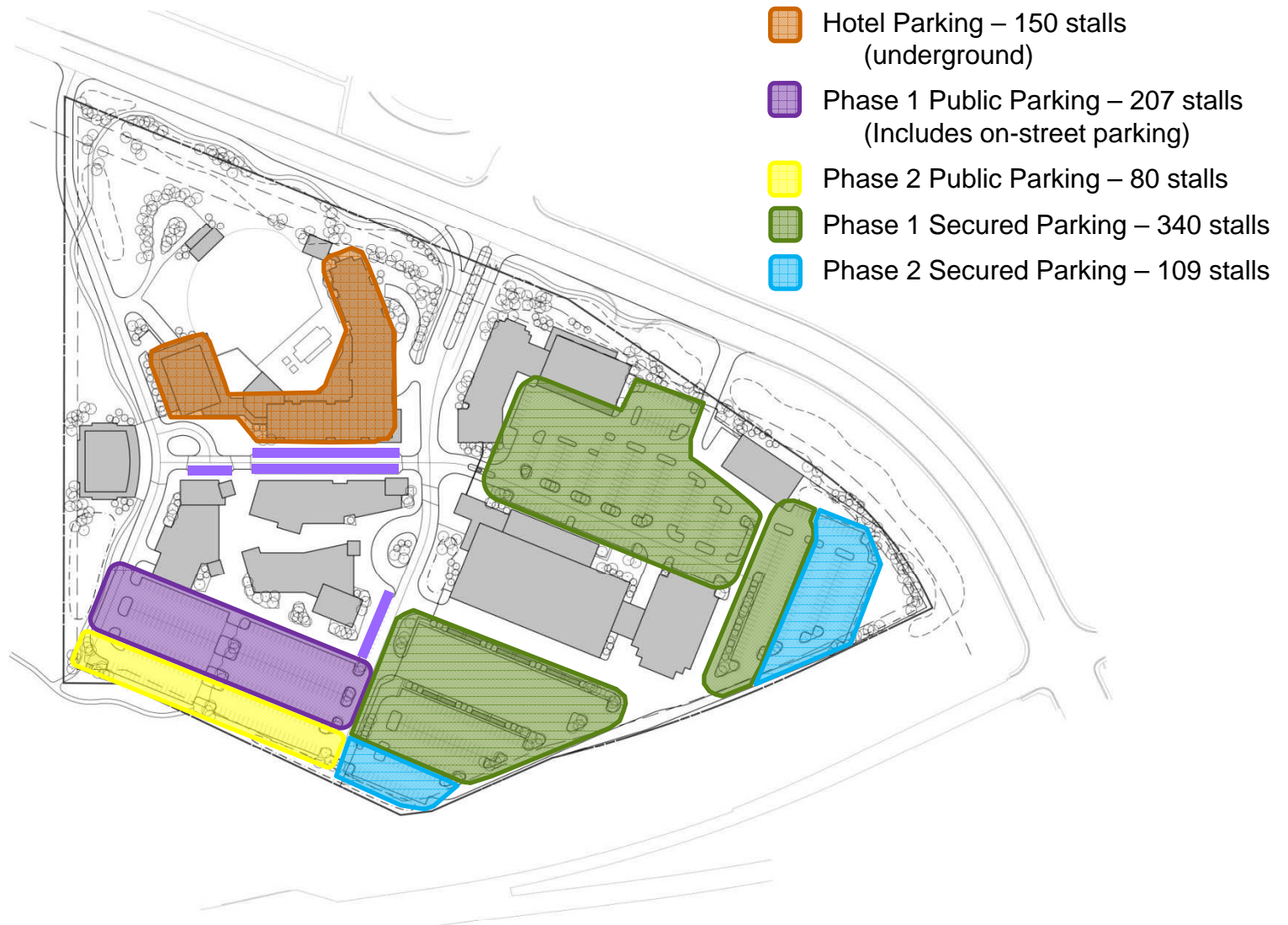

Raleigh Studios – Access/Circulation (Public Access)

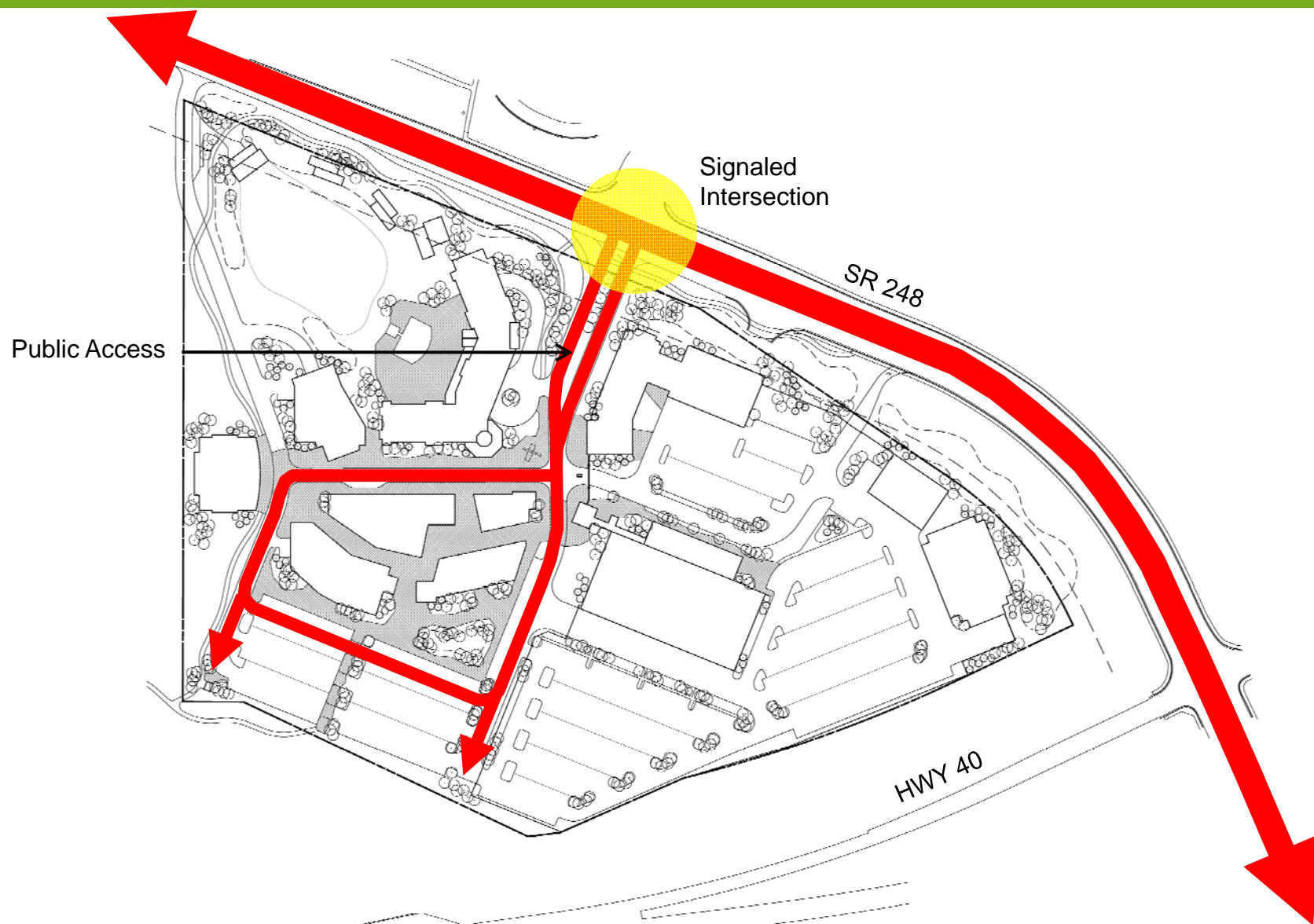

Raleigh Studios – Public Transit Plan

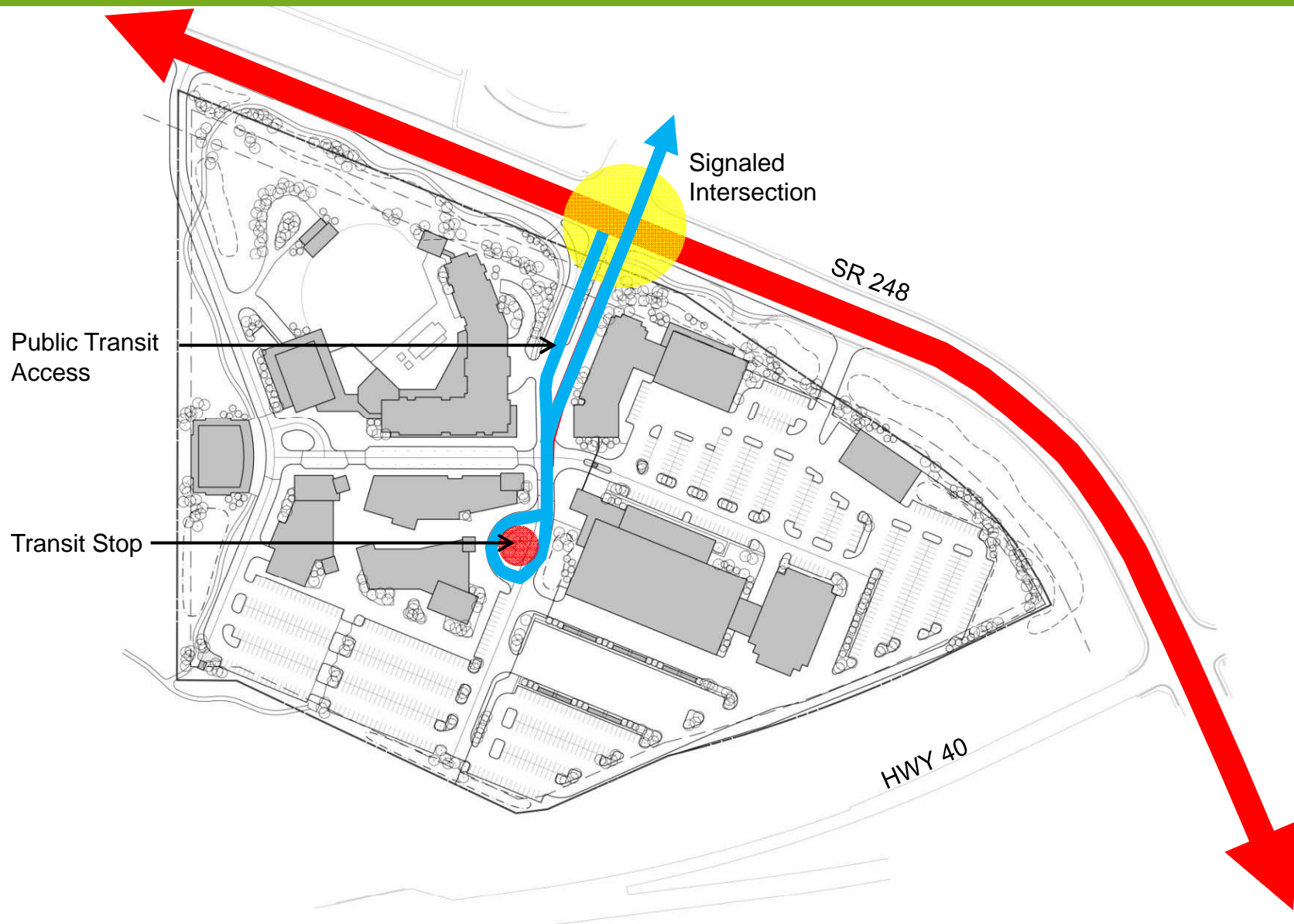

Raleigh Studios – Access/Circulation (Service)

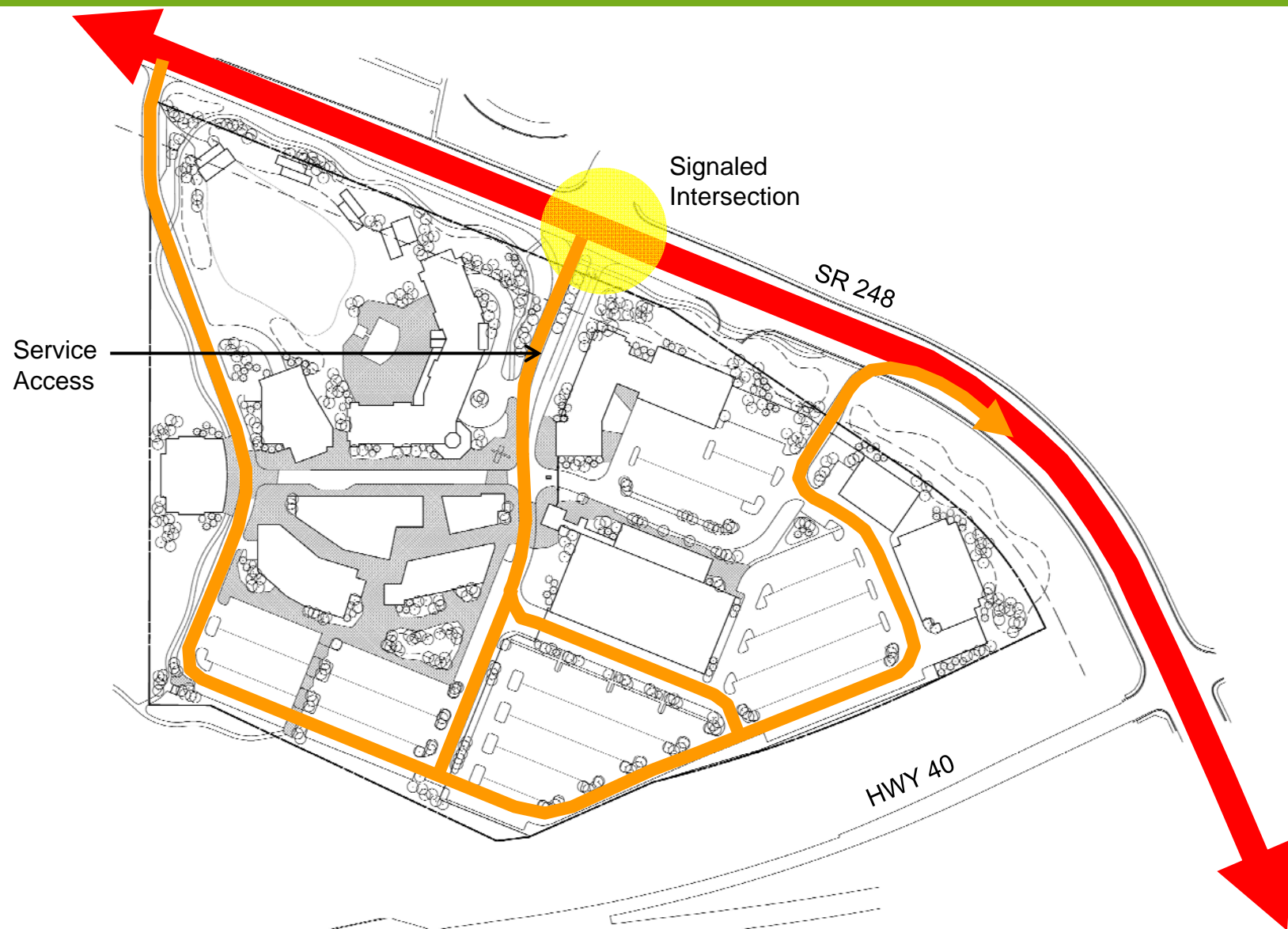

Raleigh Studios – Access/Circulation (Trails)

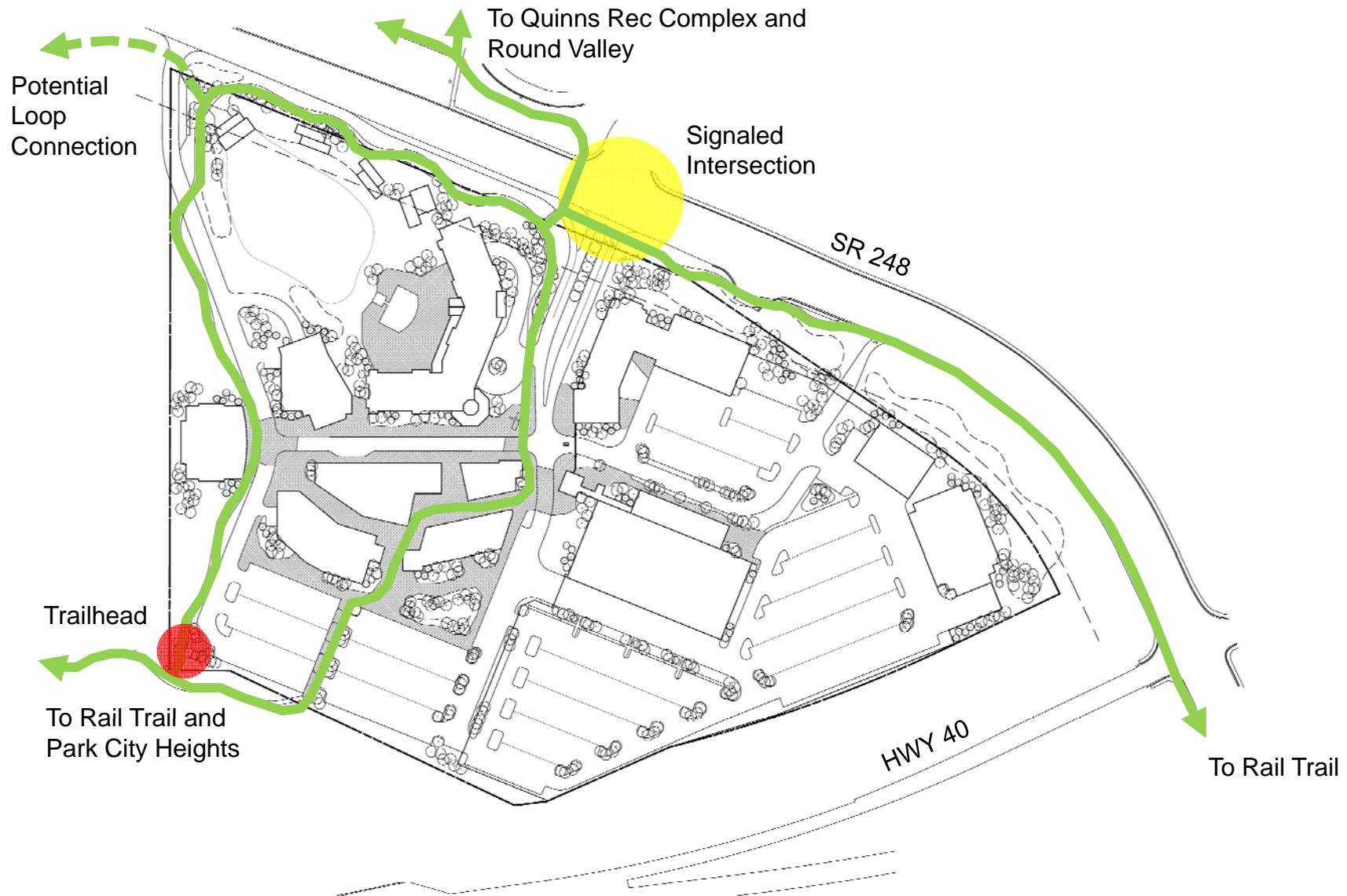

Raleigh Studios – Setback Distances

25' minimum setback to all buildings

Building Legend

- 1A Hotel Lodging
- 1B Recording Studio
- 1C Stage Venue
- 1D Residence - omitted
- 1E Grand Ball Room
- 1F Atrium
- 2 Screening Rooms/Theater
- 3 Entertainment Venue
- 4 Mixed Use
- 5 Mixed Use
- 6 Sound Effects Stage
- 6A Office, Effects Stage
- 7 Sound Stages
- 7A Workshop
- 7B Production Support/ Offices
- 8 Workshop Office



Raleigh Studios – Conceptual Berm Grading

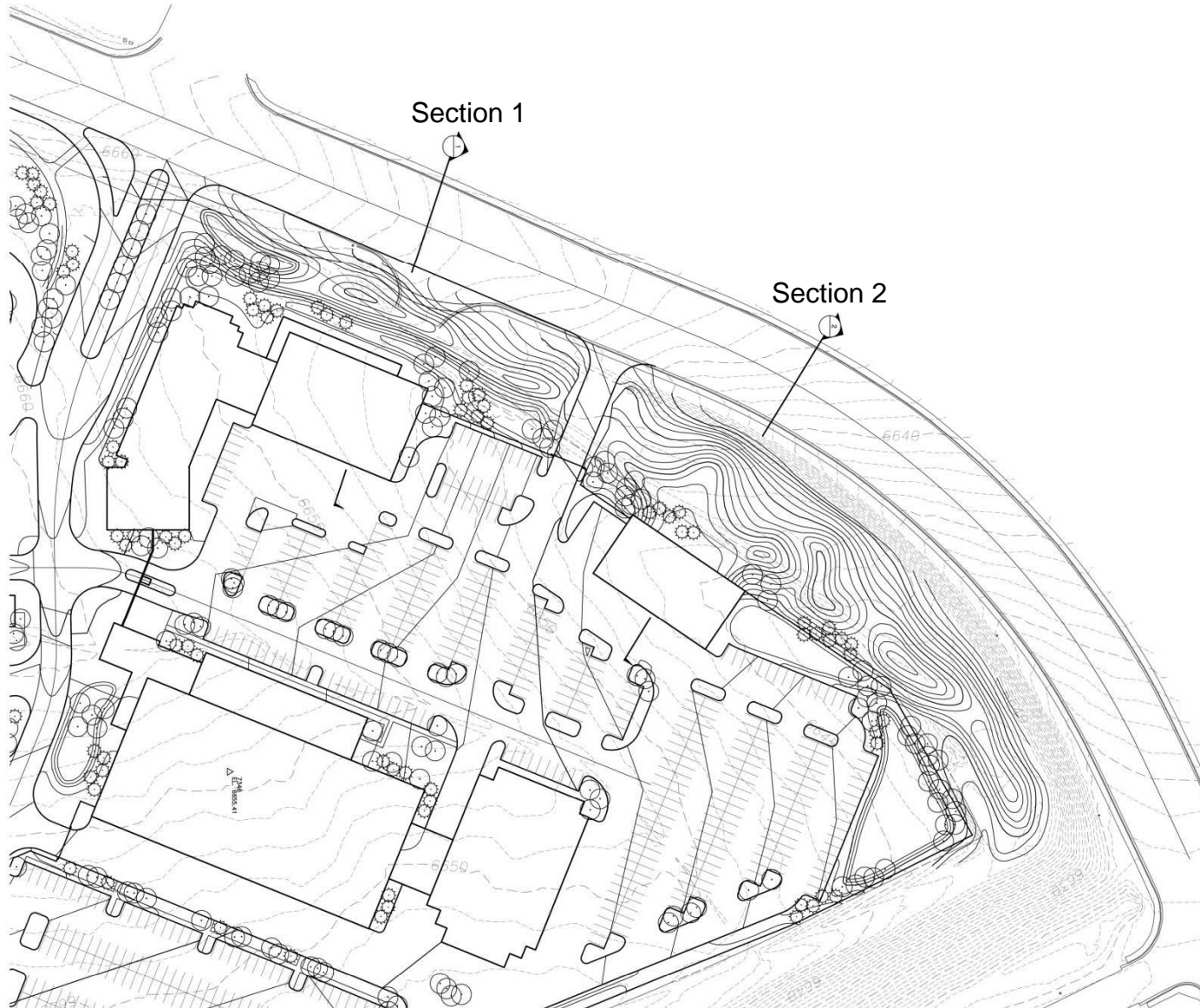

Raleigh Studios – Section 1

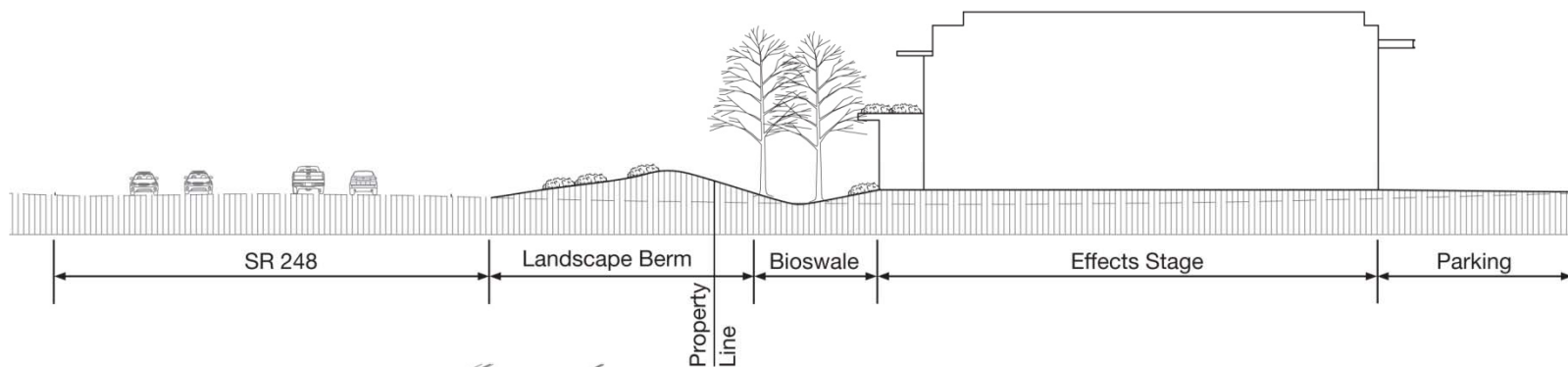

0 20 40 80 Feet

Horizontal Scale: 1" = 20'-0"
Vertical Scale: 1" = 20'-0"

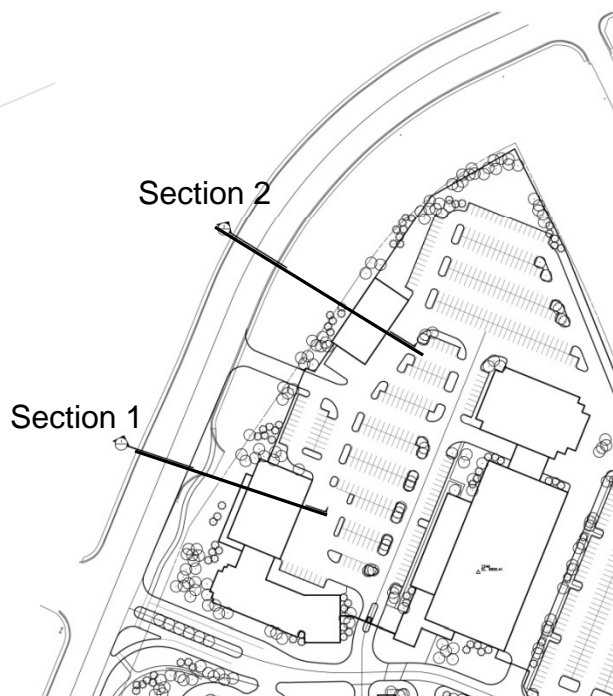

Raleigh Studios – Section 2

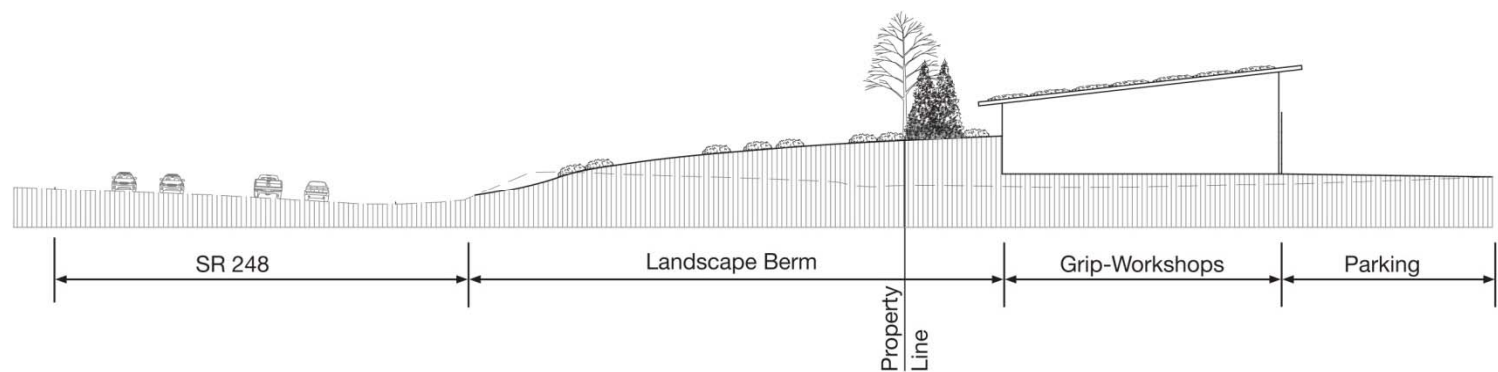

0 20 40 80 Feet
Horizontal Scale: 1" = 20'-0"
Vertical Scale: 1" = 20'-0"

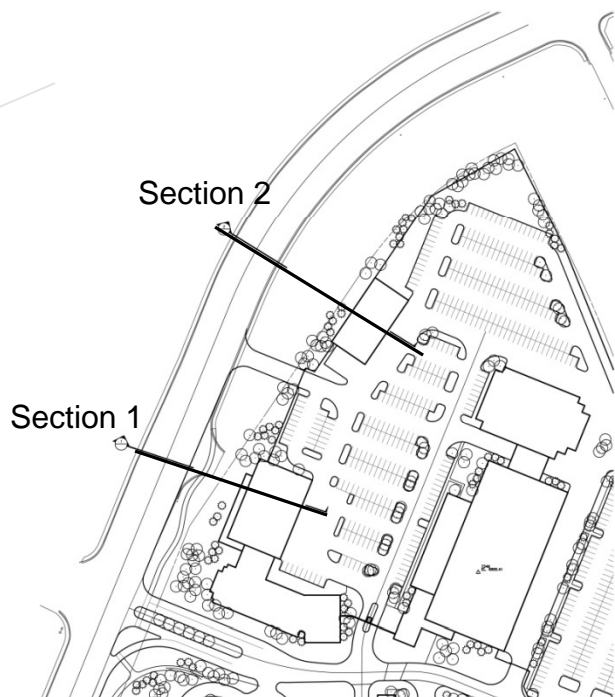

Raleigh Studios – Fencing Plan

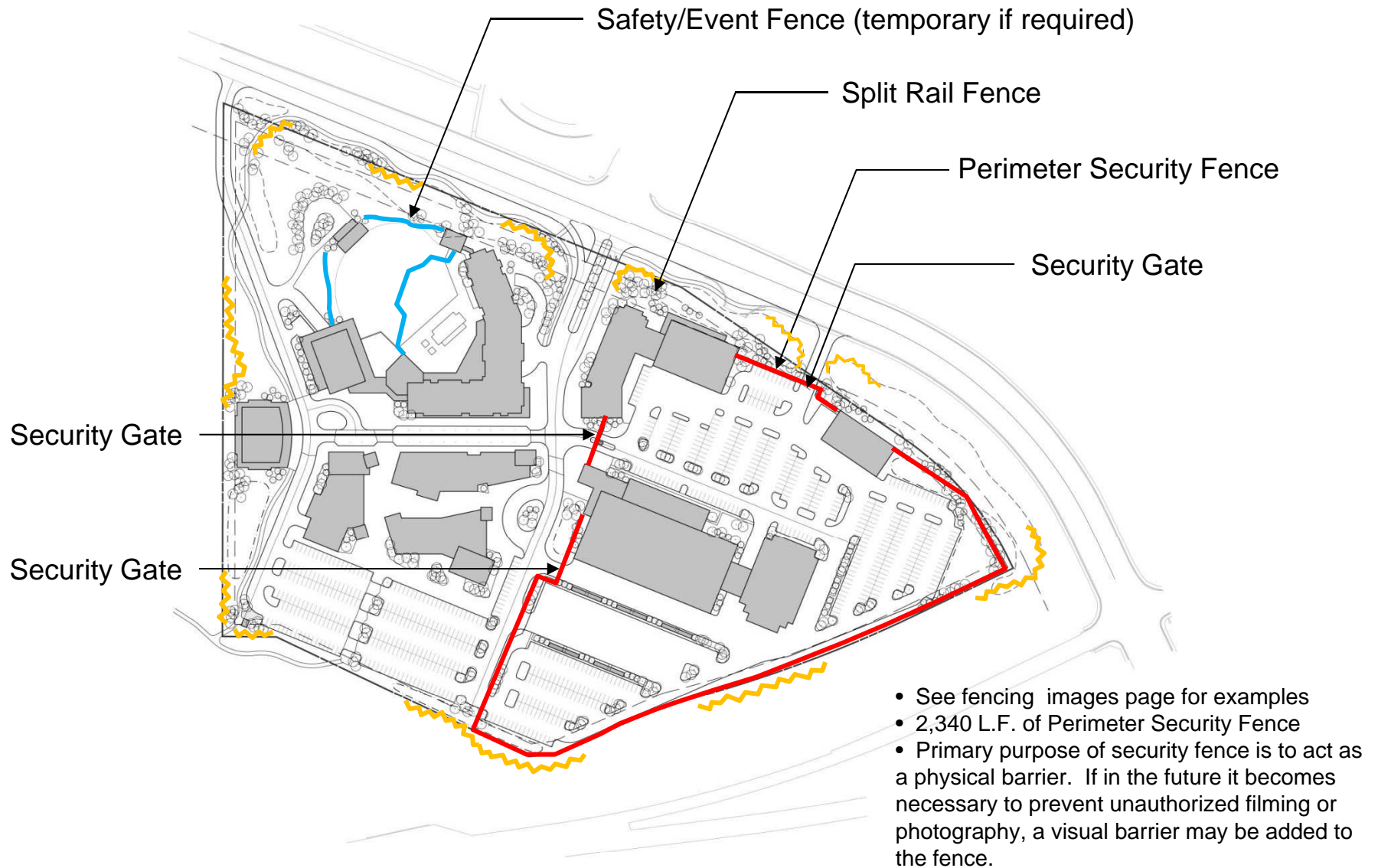

Raleigh Studios – Fencing Images



Raleigh Studios – Landscape Plan



Raleigh Studios – Landscape Images



Raleigh Studios – Landscape Images

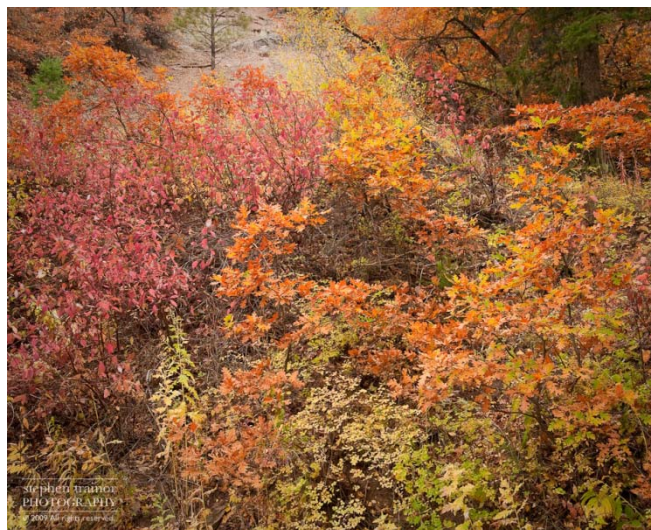

Raleigh Studios – Architectural Zones

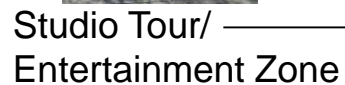

Raleigh Studios – Precedent Image Boards



SURROUNDING AREA BUILDINGS / ARCHITECTURE
PRECEDENT IMAGES

RALIEGH STUDIOS
March, 2012



Raleigh Studios
Park City, UT

Conceptual Site Plan
April 11, 2012

Raleigh Studios – Precedent Image Boards

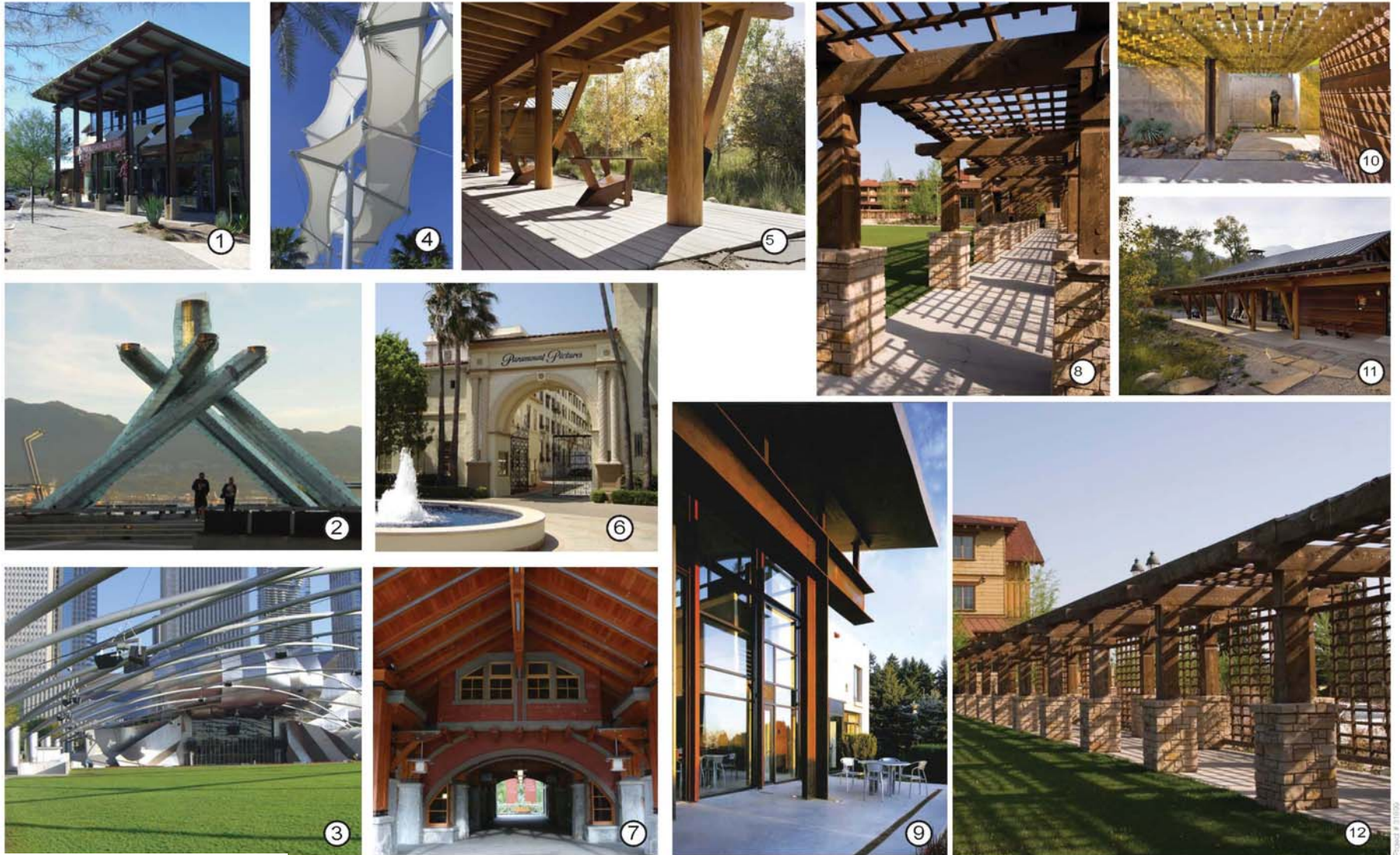

ENTRY / ARCHWAY CONCEPTS
PRECEDENT IMAGES

RALIEGH STUDIOS
March, 2012



Raleigh Studios
Park City, UT

Conceptual Site Plan
April 11, 2012

Raleigh Studios – Precedent Image Boards



ARCHITECTURAL CONCEPTS / MATERIALS
PRECEDENT IMAGES

RALIEGH STUDIOS
March, 2012



Raleigh Studios
Park City, UT

Conceptual Site Plan
April 11, 2012

Raleigh Studios – Precedent Image Boards

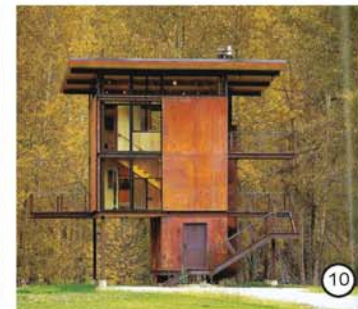

ARCHITECTURAL CONCEPTS / MATERIALS
PRECEDENT IMAGES

RALIEGH STUDIOS
March, 2012



Raleigh Studios
Park City, UT

Conceptual Site Plan
April 11, 2012

Raleigh Studios – Precedent Image Boards

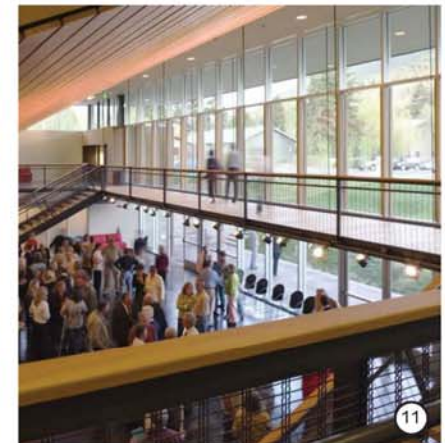
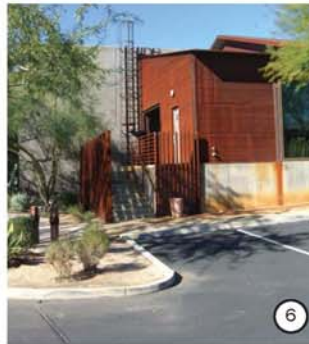

ARCHITECTURAL CONCEPTS / MATERIALS
PRECEDENT IMAGES

RALIEGH STUDIOS
March, 2012



Raleigh Studios
Park City, UT

Conceptual Site Plan
April 11, 2012

Raleigh Studios – Precedent Images



Raleigh Studios – Precedent Image Boards

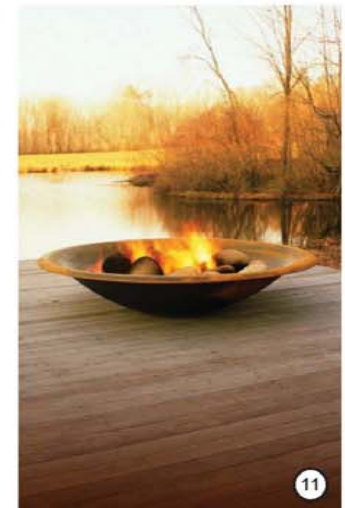

FIRE FEATURES
PRECEDENT IMAGES

RALIEGH STUDIOS
March, 2012

Project # 31092



Raleigh Studios
Park City, UT

Conceptual Site Plan
March 28, 2012

Raleigh Studios – Precedent Image Boards



HARDSCAPE / PLAZA PAVING CONCEPTS
PRECEDENT IMAGES

RALIEGH STUDIOS
March, 2012

Previous Submittal Information – March 14, 2012



Raleigh Studios – Visual Analysis



View Looking SW

Raleigh Studios – Visual Analysis



View Looking SE

Raleigh Studios – Visual Analysis



View Looking NE

Raleigh Studios – Visual Analysis



Raleigh Studios – Visual Analysis

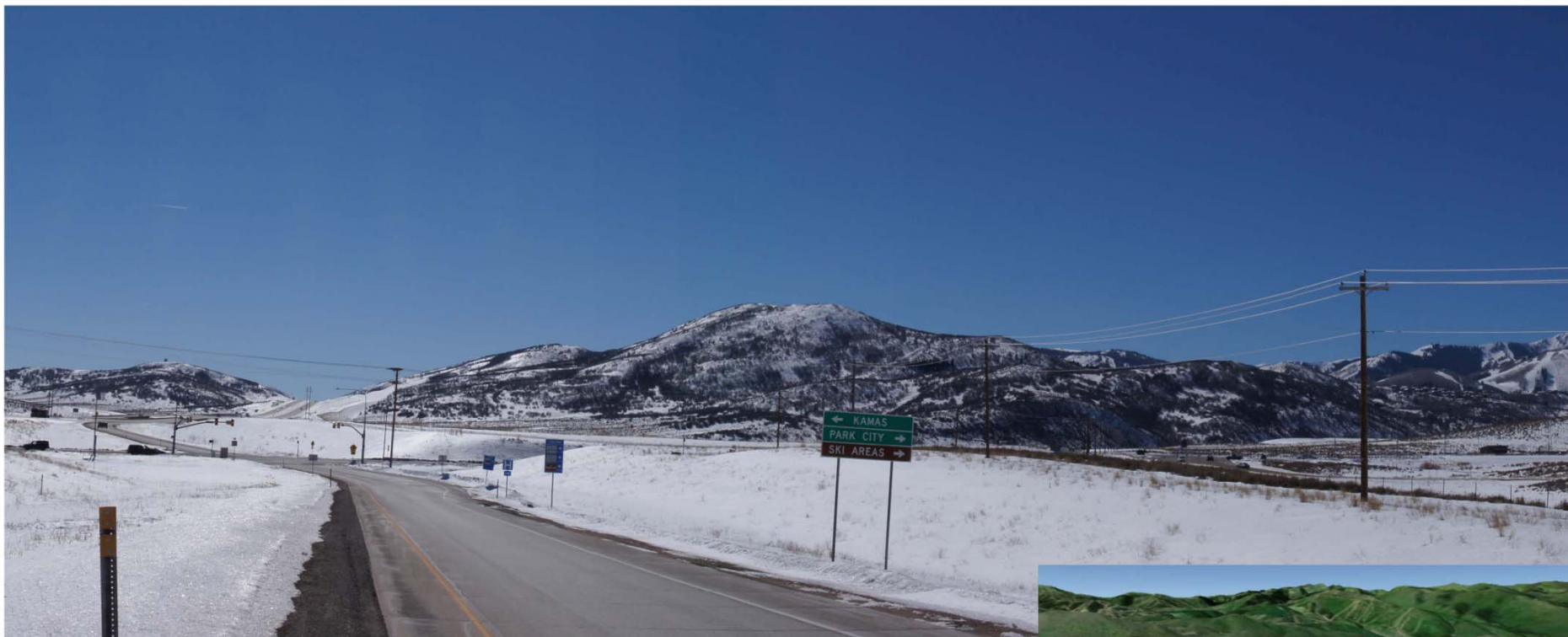

EXISTING CONDITION

VIEW LOOKING SOUTH EXITING Hwy 40 AT TOP OF OFF RAMP



Raleigh Studios – Visual Analysis



PROPOSED PROJECT

VIEW LOOKING SOUTH EXITING Hwy 40 AT TOP OF OFF RAMP



Raleigh Studios – Visual Analysis



PROPOSED PROJECT WITH BERM

VIEW LOOKING SOUTH EXITING Hwy 40 AT TOP OF OFF RAMP



Raleigh Studios
Park City, UT

Conceptual Site Plan
March 14, 2012

Raleigh Studios – Visual Analysis

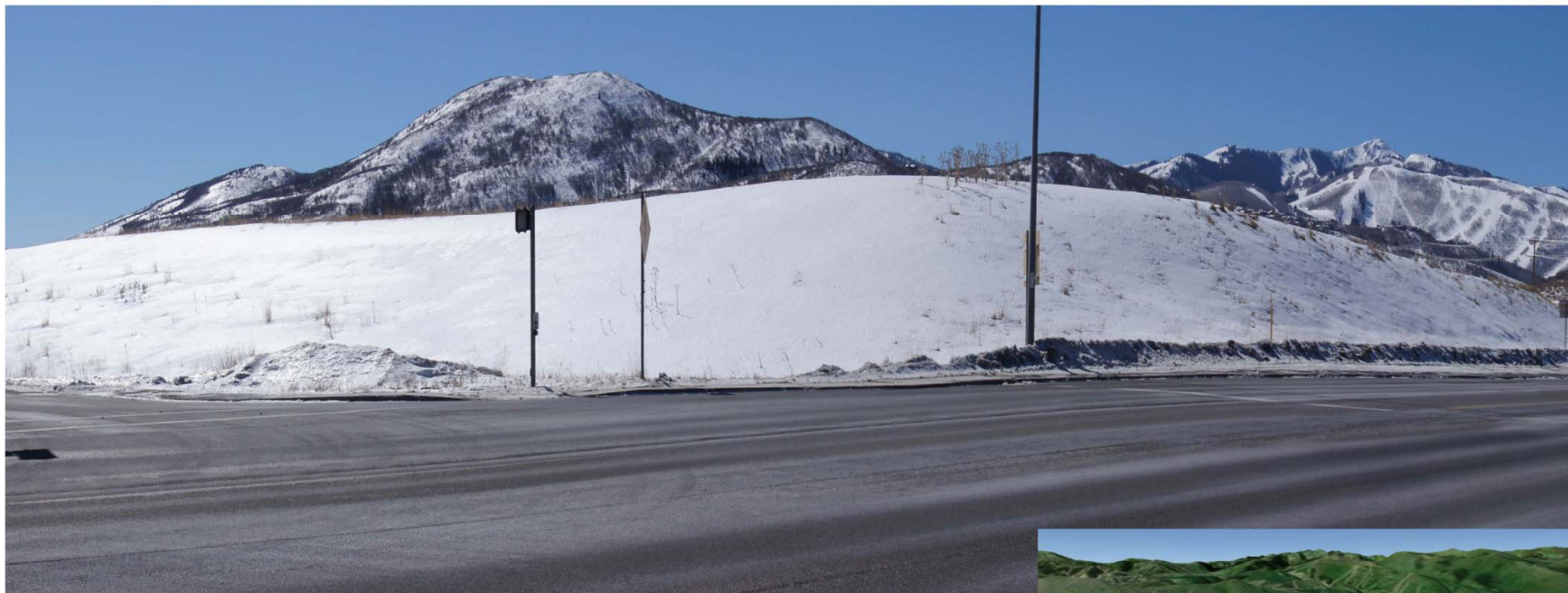

EXISTING CONDITION

VIEW LOOKING SOUTHWEST AT INTERSECTION
OF SR 248 & Hwy 40



Raleigh Studios – Visual Analysis

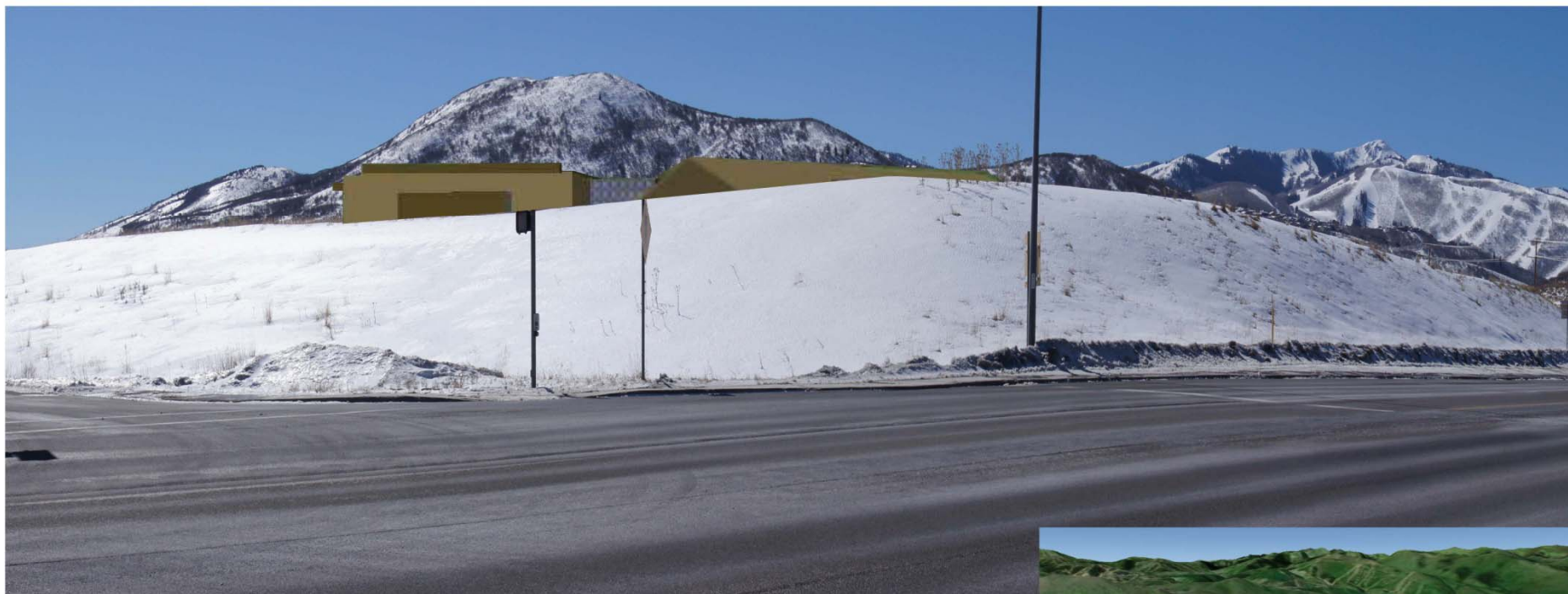

PROPOSED PROJECT

VIEW LOOKING SOUTHWEST AT INTERSECTION
OF SR 248 & Hwy 40



Raleigh Studios
Park City, UT

Conceptual Site Plan
March 14, 2012

Raleigh Studios – Visual Analysis

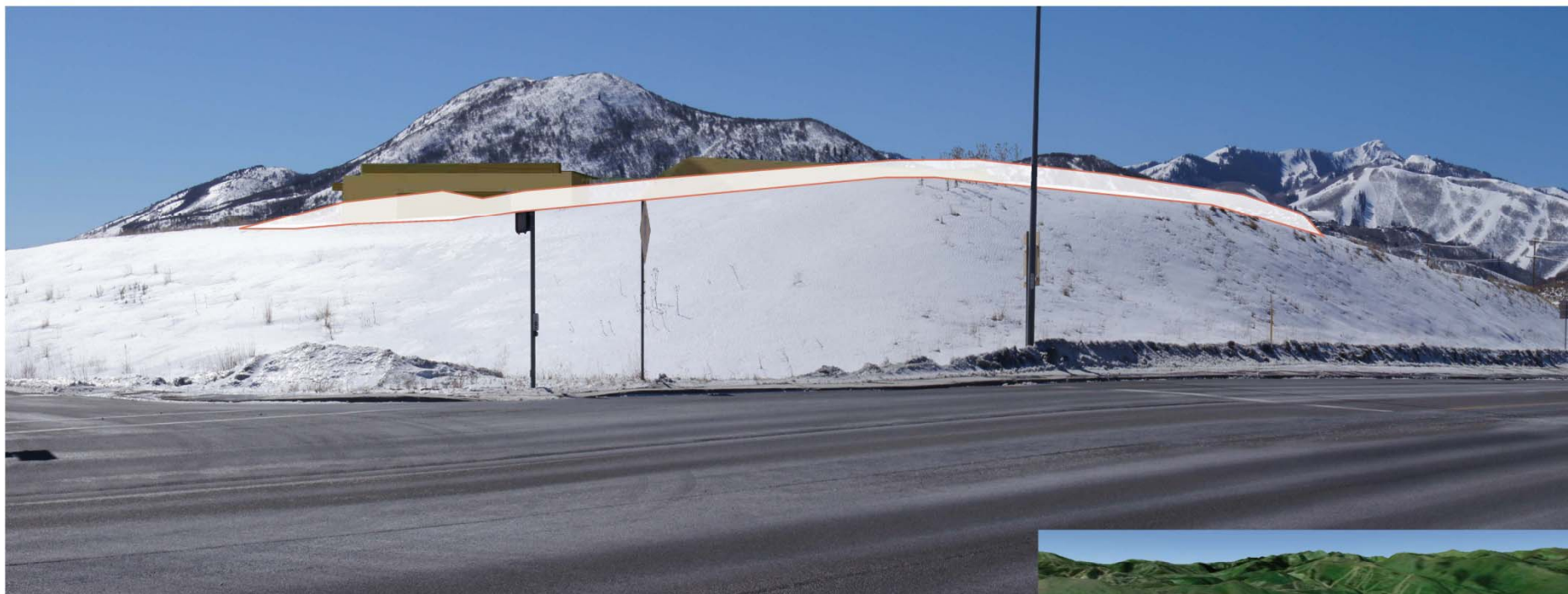

PROPOSED PROJECT WITH BERM
VIEW LOOKING SOUTHWEST AT INTERSECTION
OF SR 248 & Hwy 40



Raleigh Studios – Visual Analysis



EXISTING CONDITION

VIEW LOOKING NORTH ON SR 248



Raleigh Studios
Park City, UT

Conceptual Site Plan
March 14, 2012

Raleigh Studios – Visual Analysis



PROPOSED PROJECT

VIEW LOOKING NORTH ON SR 248



Raleigh Studios
Park City, UT

Conceptual Site Plan
March 14, 2012

Raleigh Studios – Visual Analysis



EXISTING CONDITIONS

VIEW LOOKING WEST ON SR 248 FROM
RICHARDSON FLATS



Raleigh Studios – Visual Analysis



PROPOSED PROJECT

VIEW LOOKING WEST ON SR 248 FROM
RICHARDSON FLATS



Raleigh Studios – Conceptual Site Plan



Raleigh Studios – Open Space

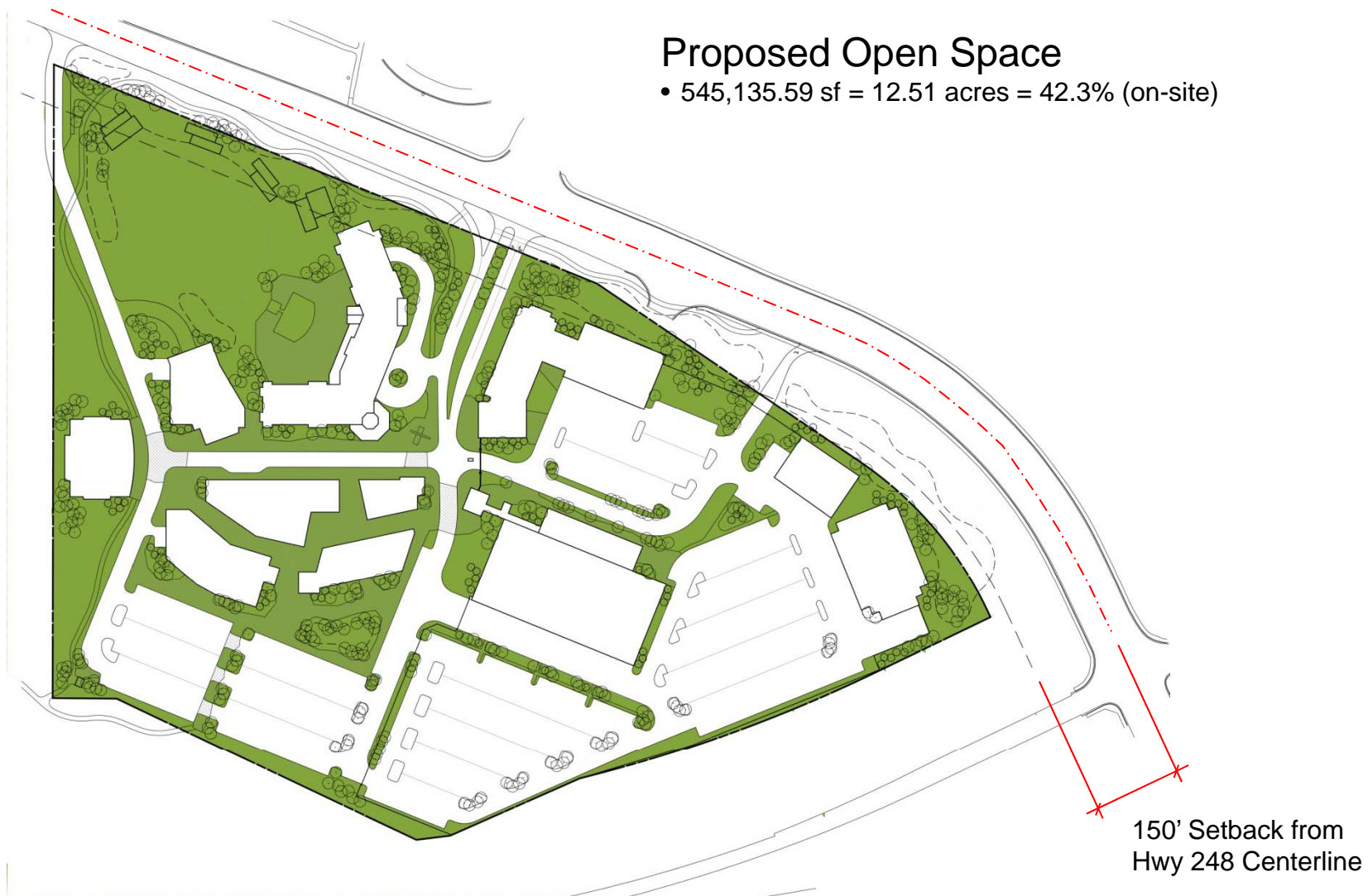

Raleigh Studios – Open Space

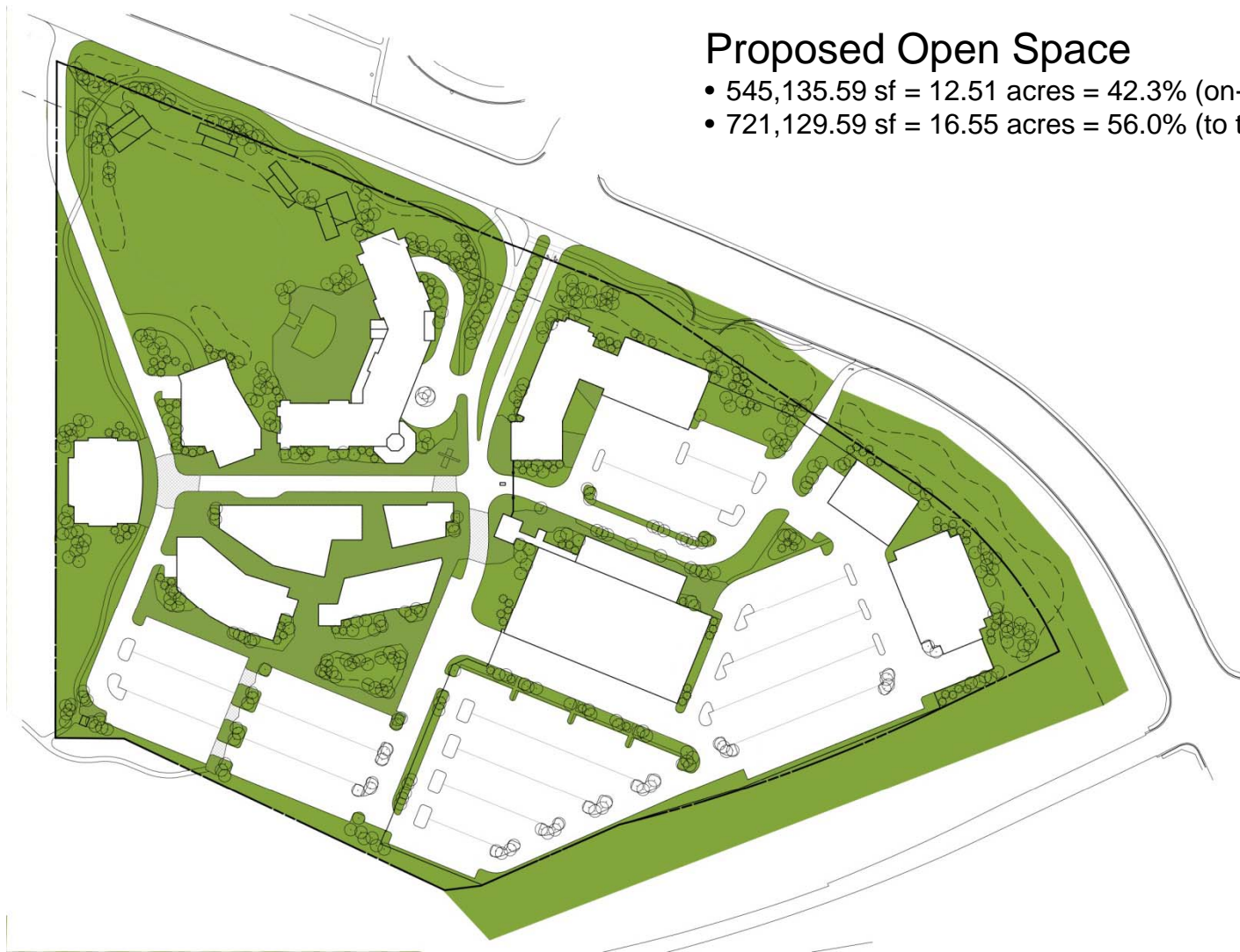

Proposed Open Space

- 545,135.59 sf = 12.51 acres = 42.3% (on-site)
- 721,129.59 sf = 16.55 acres = 56.0% (to top of cut bank)

Raleigh Studios – Open Space

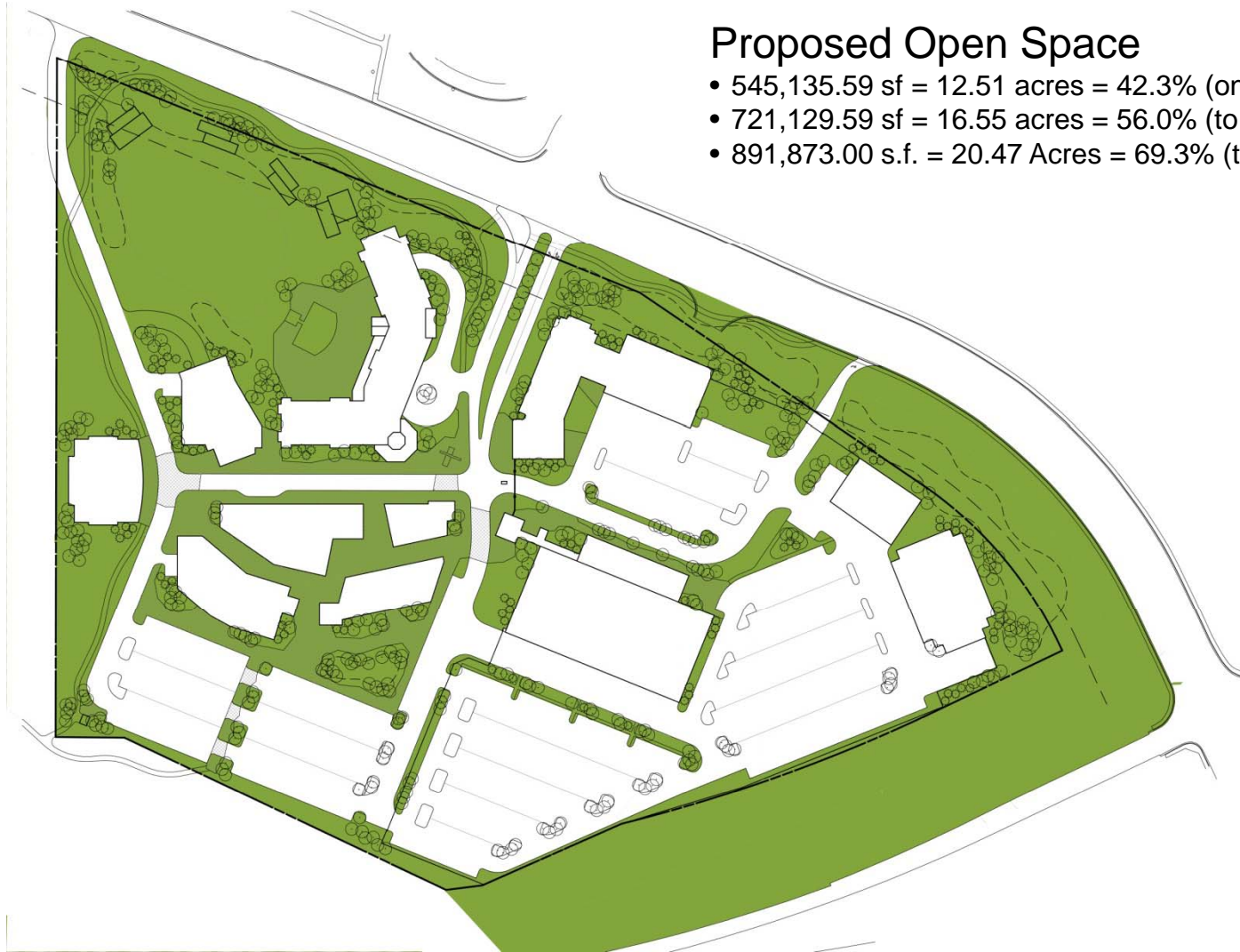

Proposed Open Space

- 545,135.59 sf = 12.51 acres = 42.3% (on-site)
- 721,129.59 sf = 16.55 acres = 56.0% (to top of cut bank)
- 891,873.00 s.f. = 20.47 Acres = 69.3% (to edge of 248/40)

Raleigh Studios – Access/Circulation (Transit)

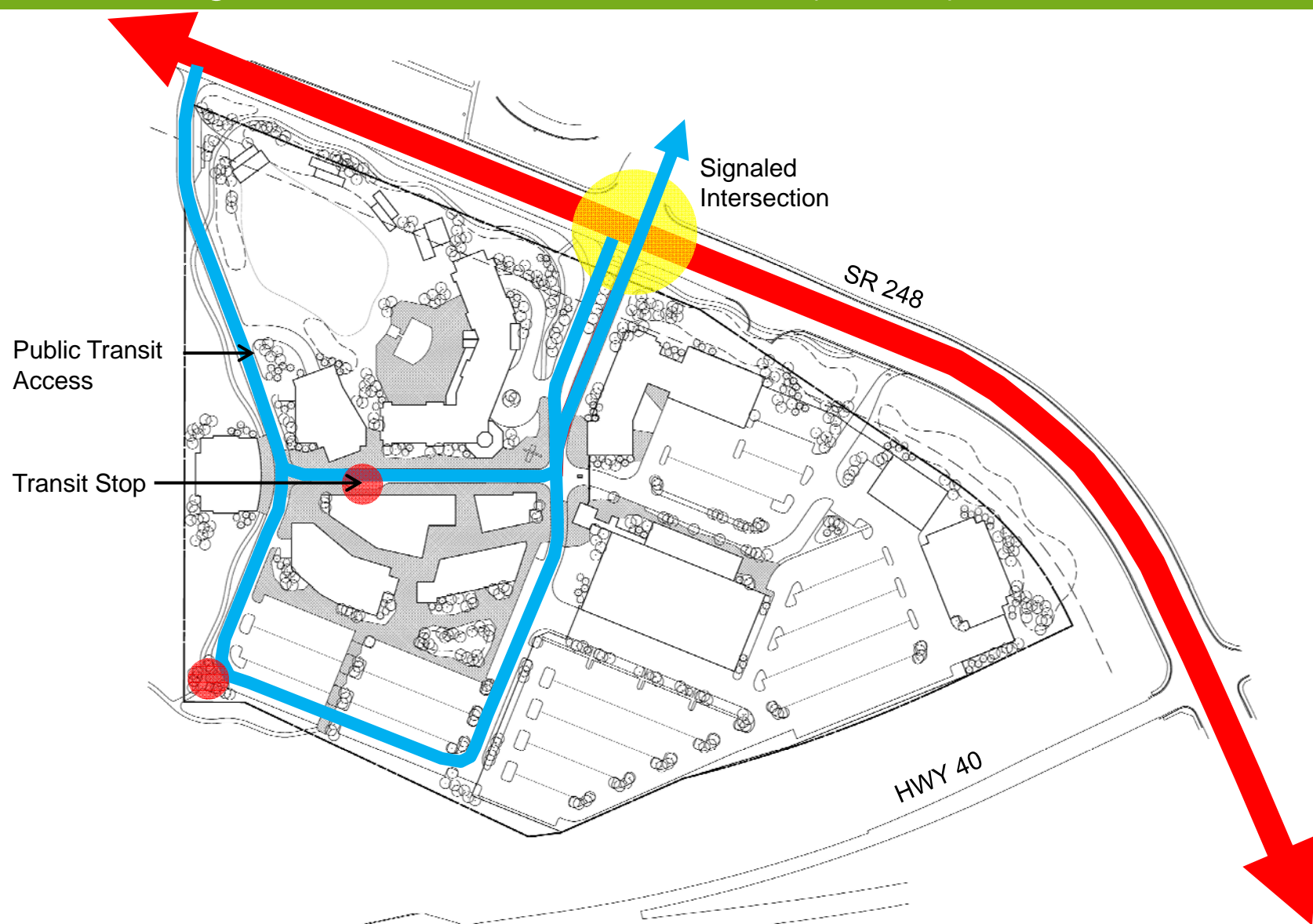

Raleigh Studios – Parking

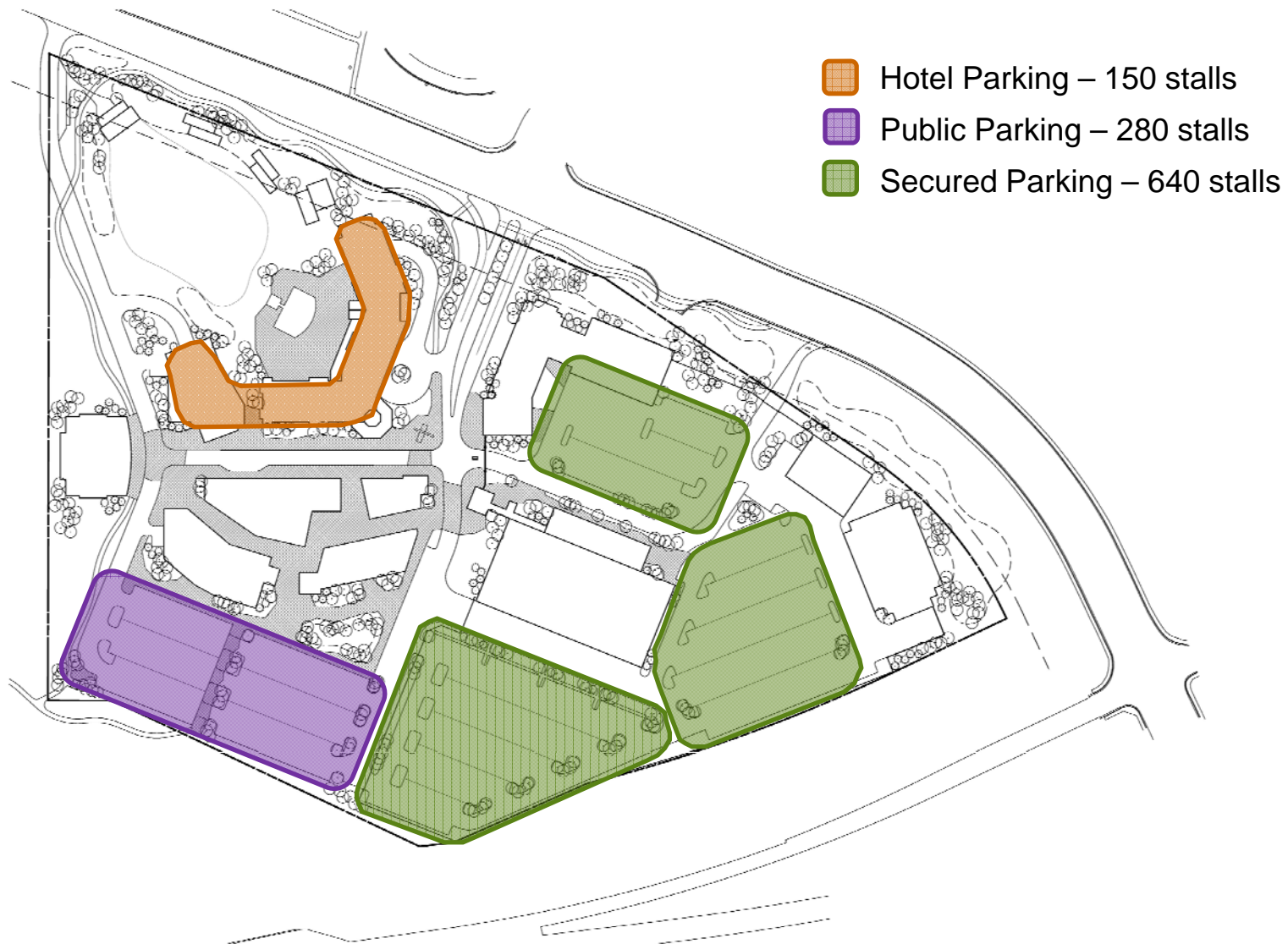

Raleigh Studios – Precedent Images (Studio Retail)



Raleigh Studios – Precedent Images (Architecture/Character)



Raleigh Studios – Precedent Images (Site Plans)



Insight Film Studios – Vancouver, British Columbia

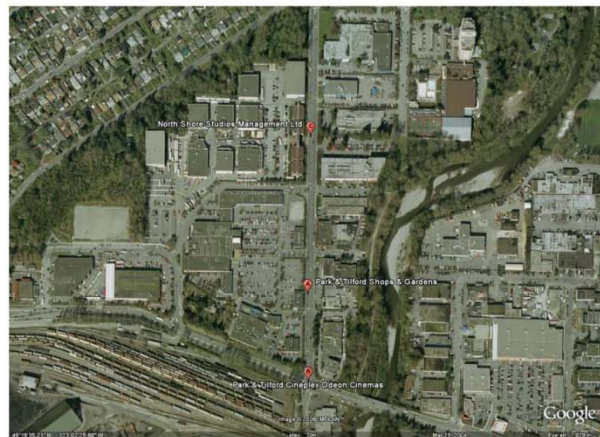

North Shore Studios – Vancouver, British Columbia



Northern Film & Media – Newcastle, England



Pixar Animation Studios – Emeryville, California

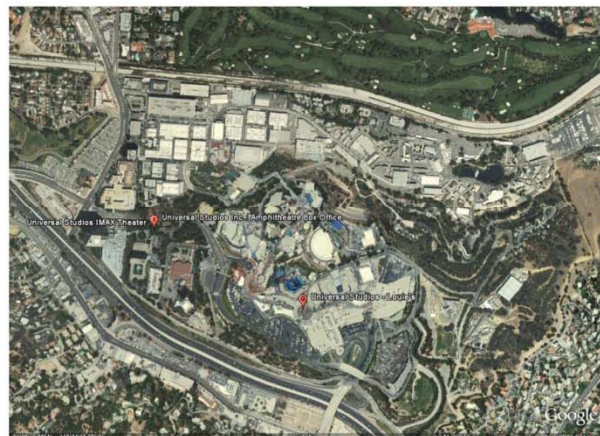

Universal Studios – Hollywood, California



Lions Gate Studio – Vancouver, British Columbia

Raleigh Studios – Community Visioning Filter

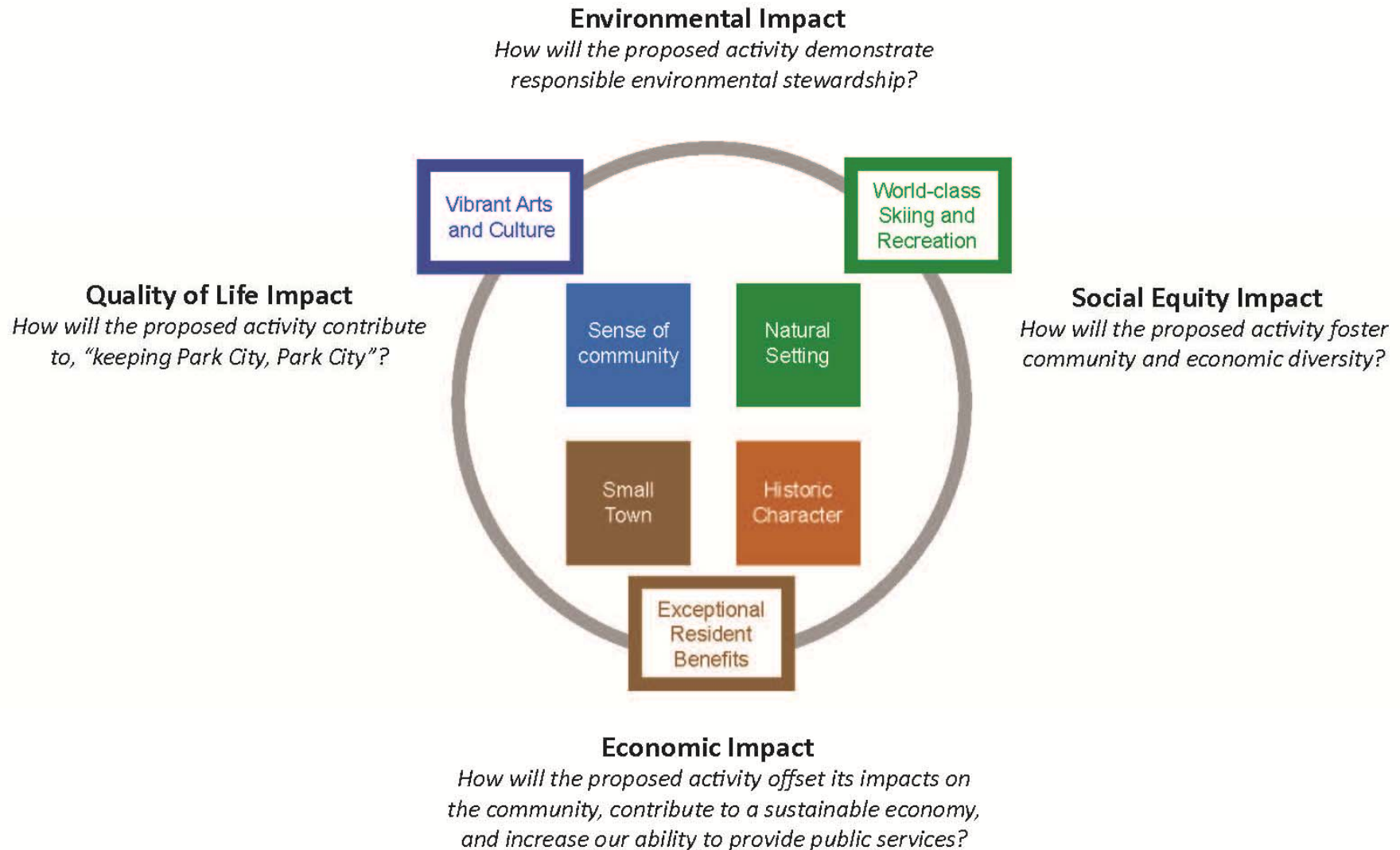

Raleigh Studios – Community Visioning Filter

- 1 Quality of Life Impact – “keeping Park City, Park City”**
 - Embrace, showcase and encourage arts and culture
 - Contribute to a year-round offering of uses and activities
 - Enhance the community trail network
 - Attract diverse demographic
 - Improve transportation needs of visitors and residents
- 2 Economic Impact – “contribute to a sustainable economy and provide public services”**
 - Increased tax base to the resort economy
 - Diversify the local economy through art and culture based industry
 - Increase national, regional and local employment offerings
 - Enhance the tourism economy through unique attractions
 - Nurture and grow the success of the Sundance Film Festival
 - Promote the film industry within the State of Utah
 - Increase the international brand of Park City
- 3 Social Equity Impact – “foster community diversity”**
 - Attract the part-time and permanent resident demographic
 - Attract and enhance year-round event and activity offerings
 - Enhance community identity and image
 - Increase and diversify educational offerings
- 4 Environmental Impact – “demonstrate responsible environmental stewardship”**
 - Promote public transit and trail connections to reduce vehicle miles traveled
 - Green building design and construction to meet minimum LEED Silver Standards
 - Water conservation site design through native, drought tolerant planting strategies
 - Stormwater management to minimize and filter runoff

Raleigh Studios – General Plan Compliments

- 1 Preserve mountain resort and historic character of Park City (GP Goal 1)**
 - Complement historic and resort qualities through architectural design
 - Blend building materials and landscape character with the natural environment
 - Enhance the resort bed base and guest experience
- 2 Preserve environmental quality, open space and outdoor recreation opportunities (GP Goal 2)**
 - Focus new development at base of hills minimizing impact on ridgelines
 - Configured trails to provide outdoor recreational opportunities and connections
- 3 Maintain high quality public services and facilities (GP Goal 3)**
 - Promote public transit and trail linkages
 - Increase community facilities to meet the needs and desires of residents and visitors
 - Contribute privately to the development of community facilities
- 4 Work effectively with other governmental agencies to achieve the goals of the General Plan (GP Goal 4)**
 - Work with the State of Utah to promote the film industry
 - Collaborate with the County to benefit the local image and identity
 - Be a model community through policy and advocacy to promote a successful community
- 5 Develop an integrated transportation system to meet the needs of visitors and residents (GP Goal 10)**
 - Enhanced and expanded transit connections
 - Expanded trail network and connectivity

Previous Submittal Information – March 28, 2012



Raleigh Studios – Conceptual Site Plan Revisions



Raleigh Studios – Building Heights/Sizes

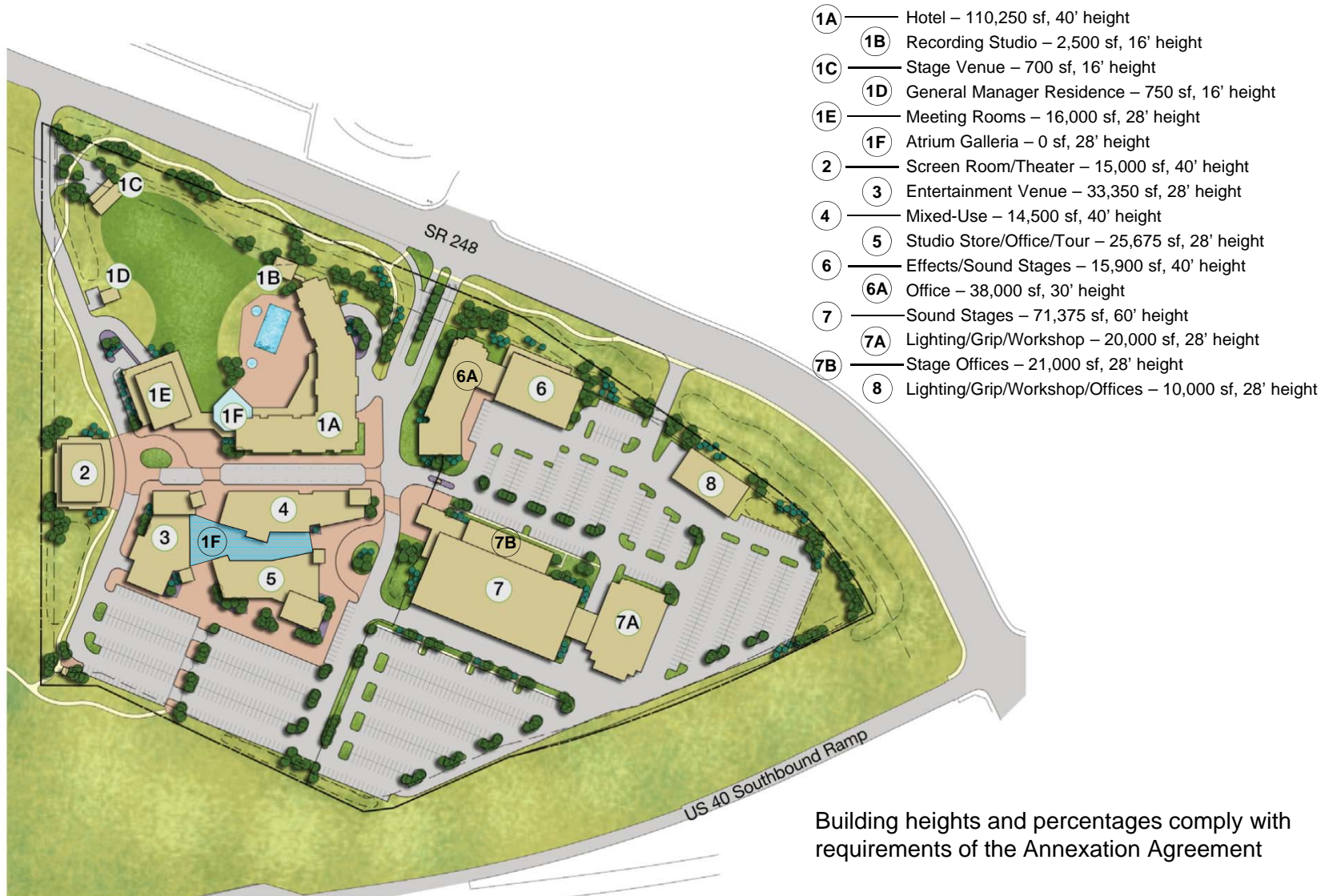

Raleigh Studios – Visual Analysis



Massing Study Looking South

Raleigh Studios – Visual Analysis



Massing Study Looking SE

Raleigh Studios – Visual Analysis



Massing Study Looking NE

Raleigh Studios – Visual Analysis

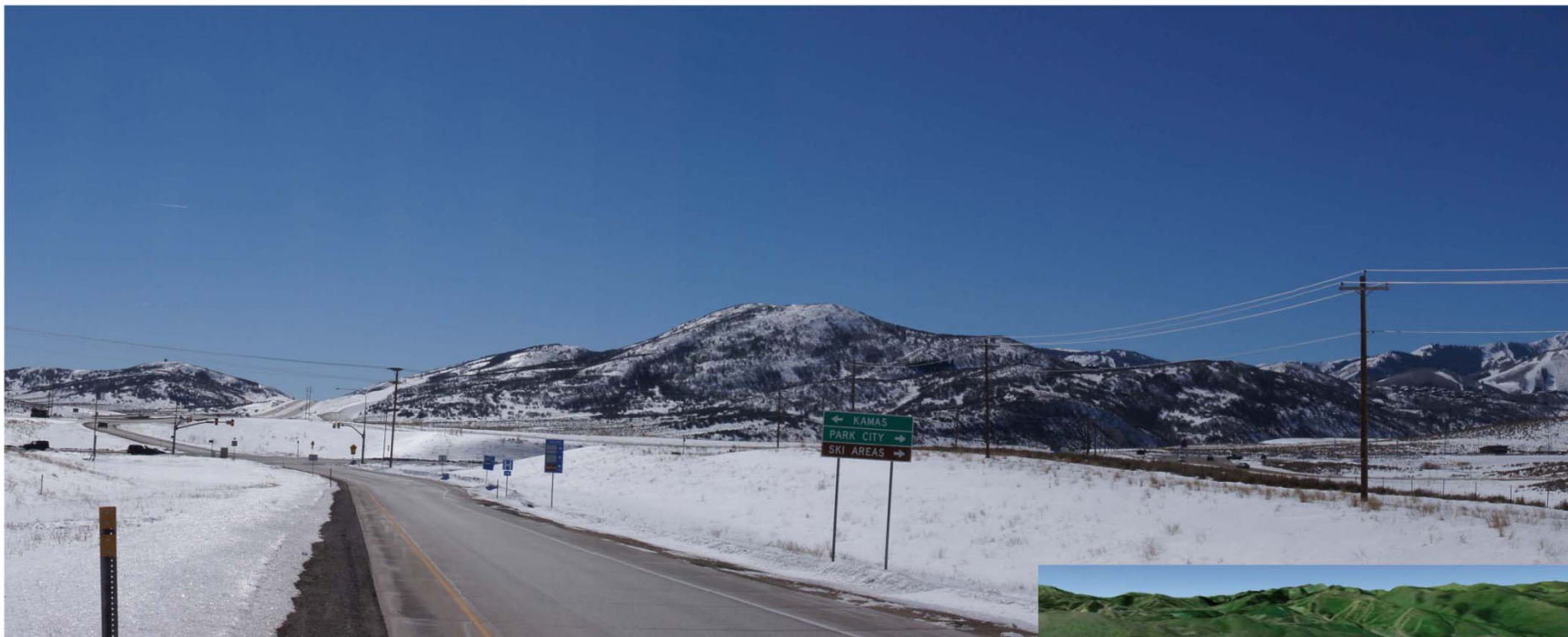

EXISTING CONDITION

VIEW LOOKING SOUTH EXITING Hwy 40 AT TOP OF OFF RAMP



Raleigh Studios – Visual Analysis



PROPOSED PROJECT WITH BERM

VIEW LOOKING SOUTH EXITING Hwy 40 AT TOP OF OFF RAMP



Raleigh Studios
Park City, UT

Conceptual Site Plan
March 28, 2012

Raleigh Studios – Visual Analysis

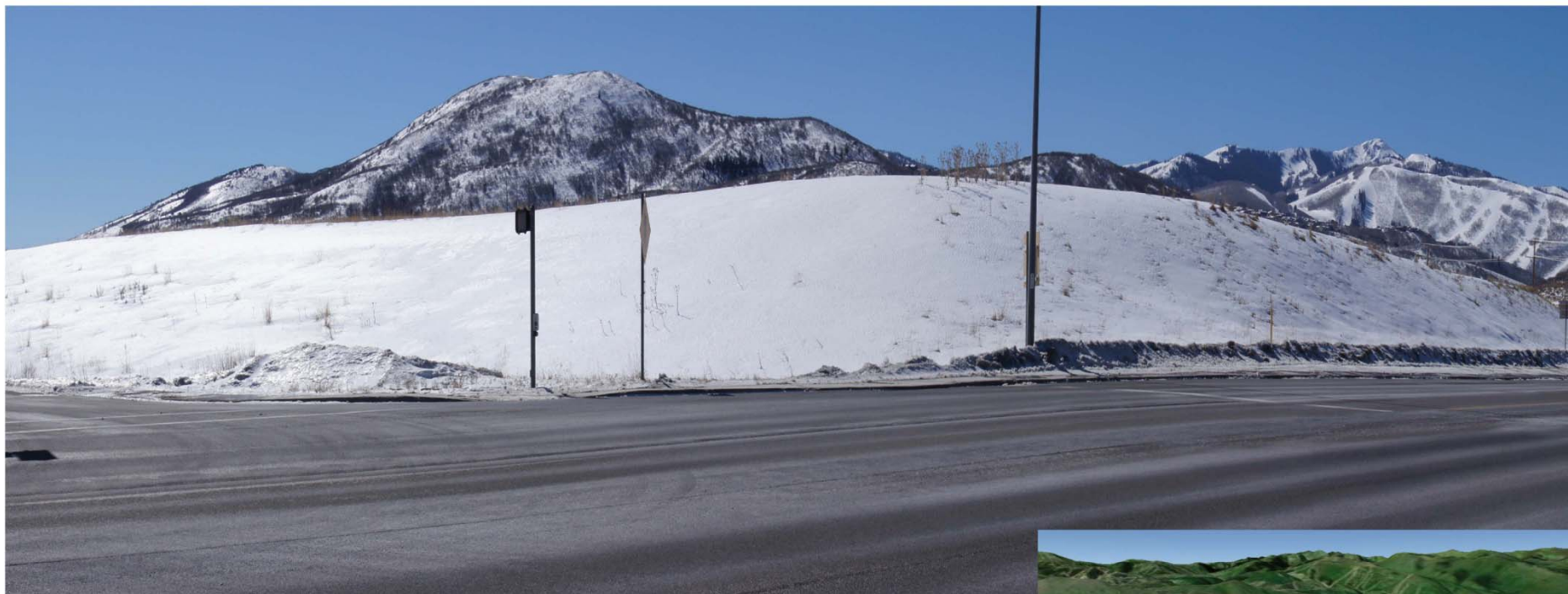

EXISTING CONDITION

VIEW LOOKING SOUTHWEST AT INTERSECTION
OF SR 248 & Hwy 40



Raleigh Studios – Visual Analysis



PROPOSED PROJECT WITH BERM
VIEW LOOKING SOUTHWEST AT INTERSECTION
OF SR 248 & Hwy 40



Raleigh Studios – Visual Analysis



EXISTING CONDITION

VIEW LOOKING NORTH ON SR 248



Raleigh Studios – Visual Analysis



PROPOSED PROJECT

VIEW LOOKING NORTH ON SR 248



Raleigh Studios
Park City, UT

Conceptual Site Plan
March 28, 2012

Raleigh Studios – Visual Analysis



PROPOSED PROJECT
VIEW LOOKING NORTH ON SR 248



Raleigh Studios – Visual Analysis



EXISTING CONDITIONS

VIEW LOOKING WEST ON SR 248 FROM
RICHARDSON FLATS



Raleigh Studios – Visual Analysis



PROPOSED PROJECT

VIEW LOOKING WEST ON SR 248 FROM
RICHARDSON FLATS



Raleigh Studios – Visual Analysis



View Looking SW on SR 248

Raleigh Studios – Open Space

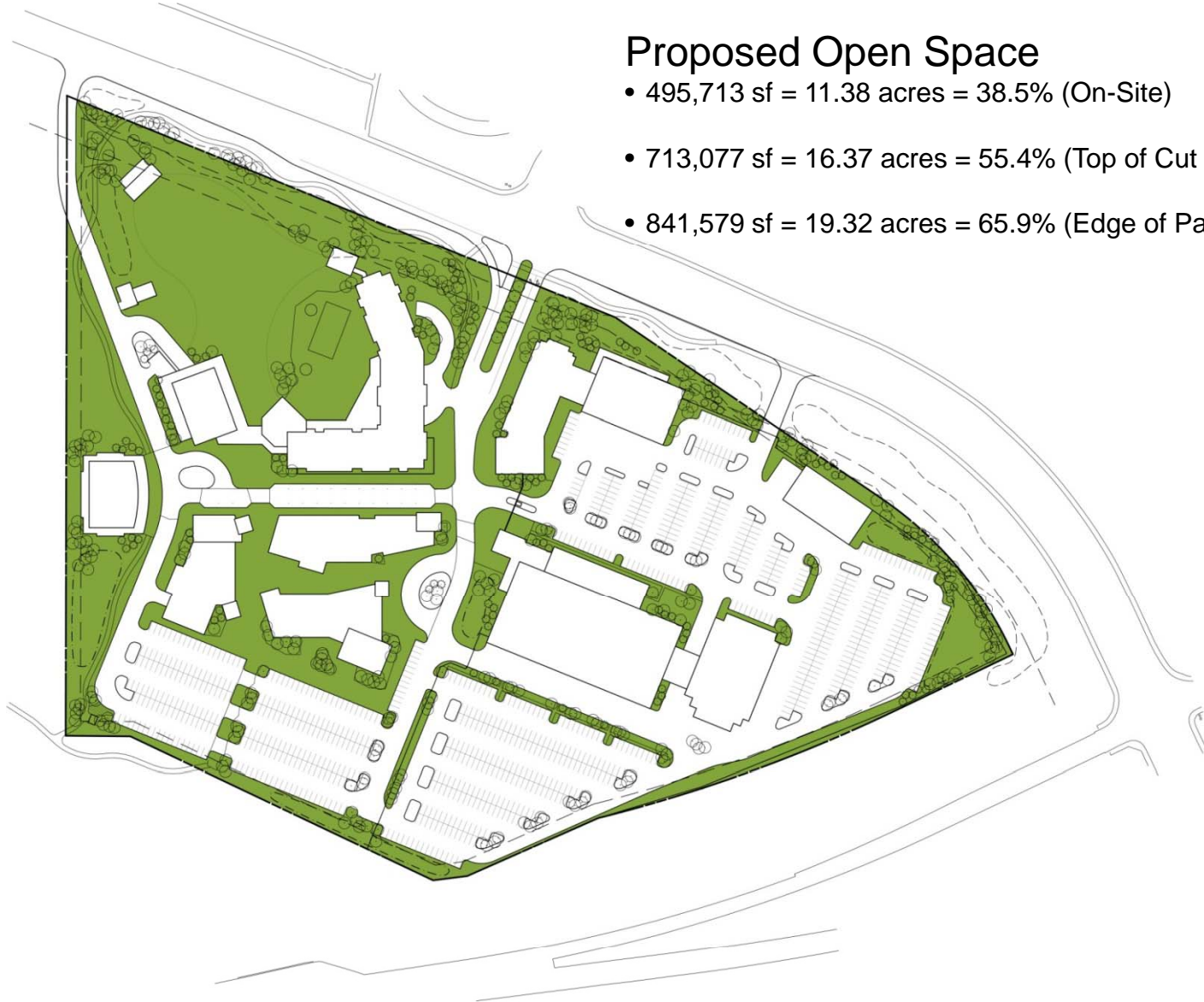

Proposed Open Space

- 495,713 sf = 11.38 acres = 38.5% (On-Site)
- 713,077 sf = 16.37 acres = 55.4% (Top of Cut Slope)
- 841,579 sf = 19.32 acres = 65.9% (Edge of Pavement)

Raleigh Studios – Parking Plan w/Counts

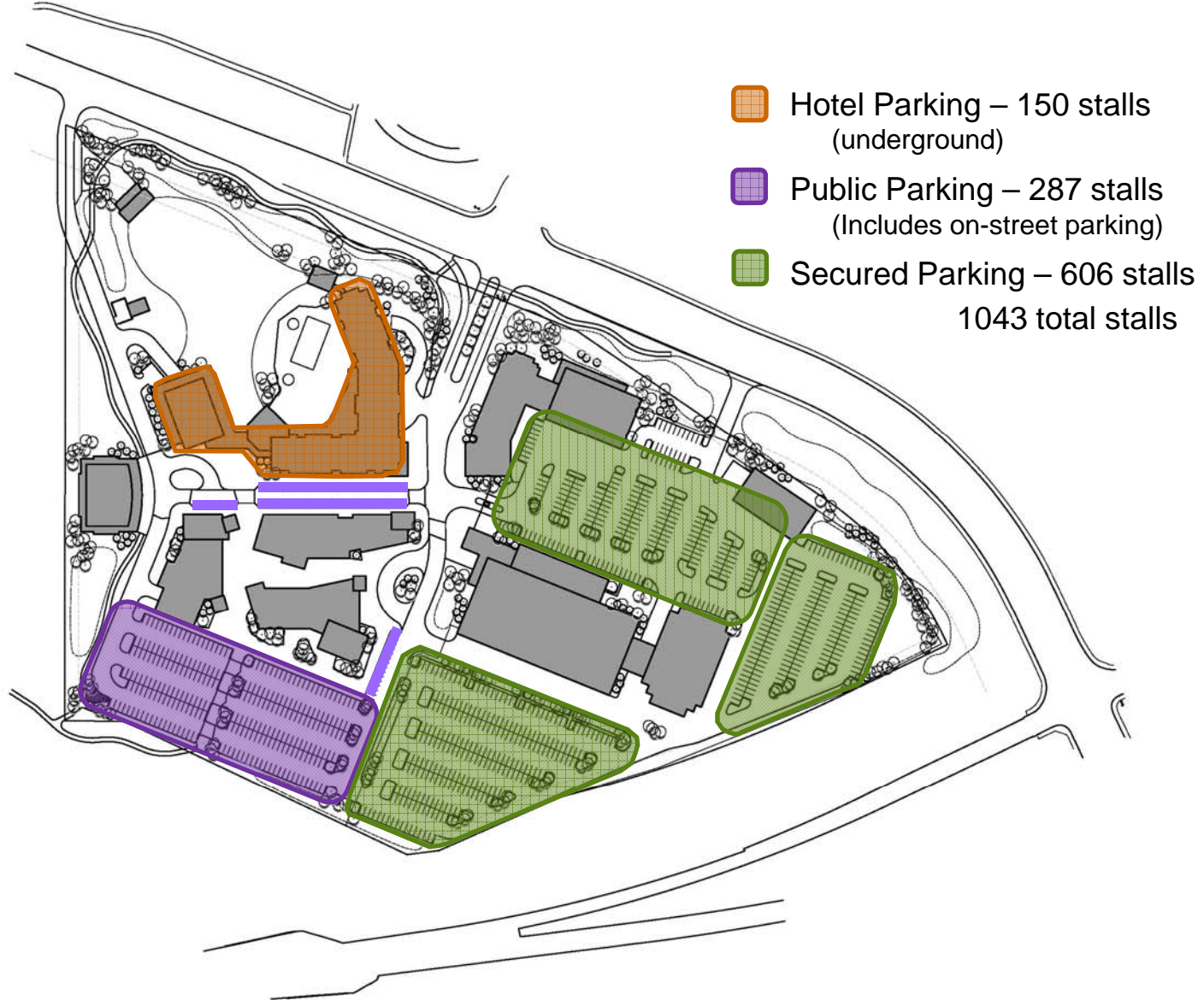

Raleigh Studios – Fencing Plan

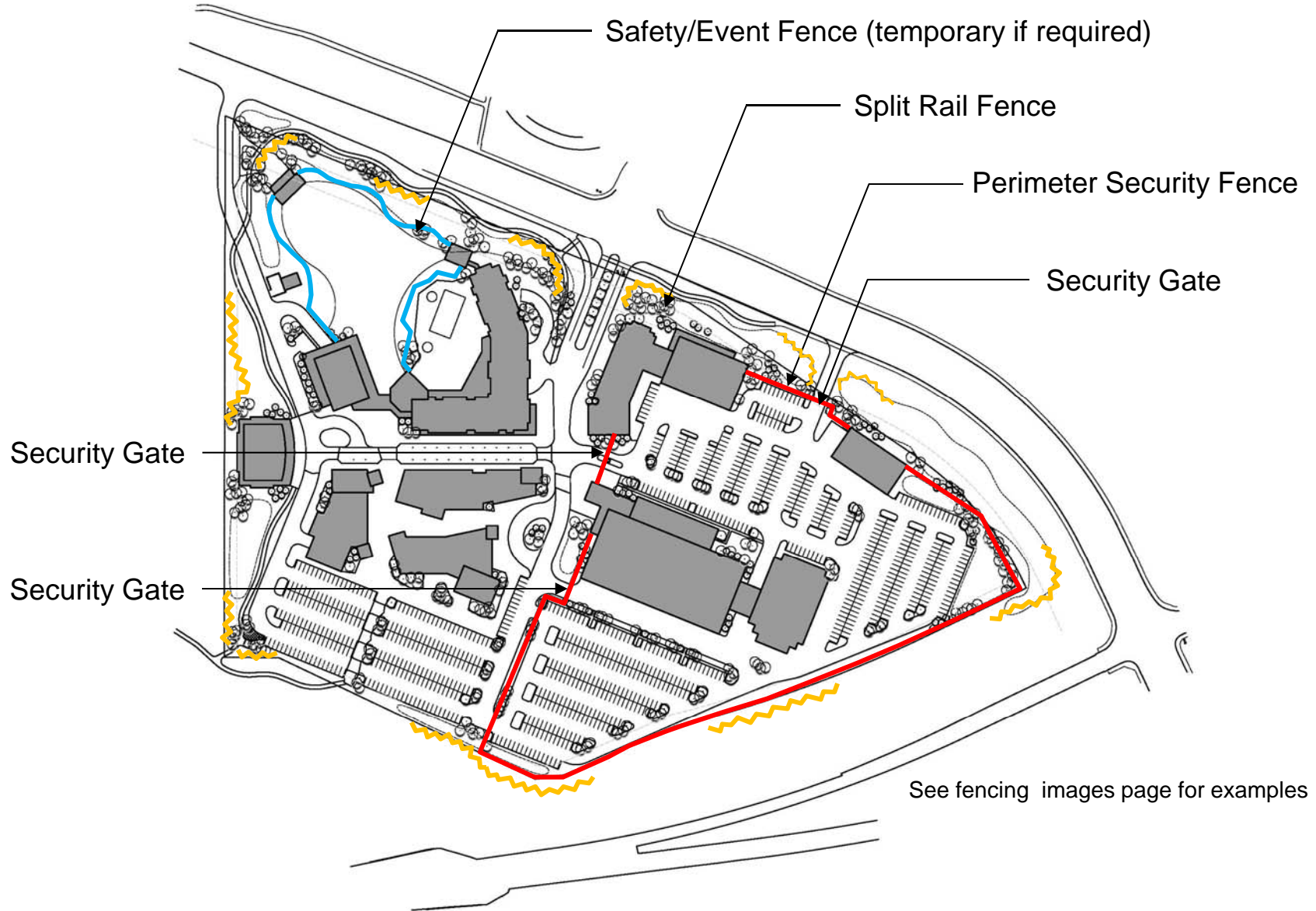

Raleigh Studios – Fencing Images



Raleigh Studios – Architectural Zones

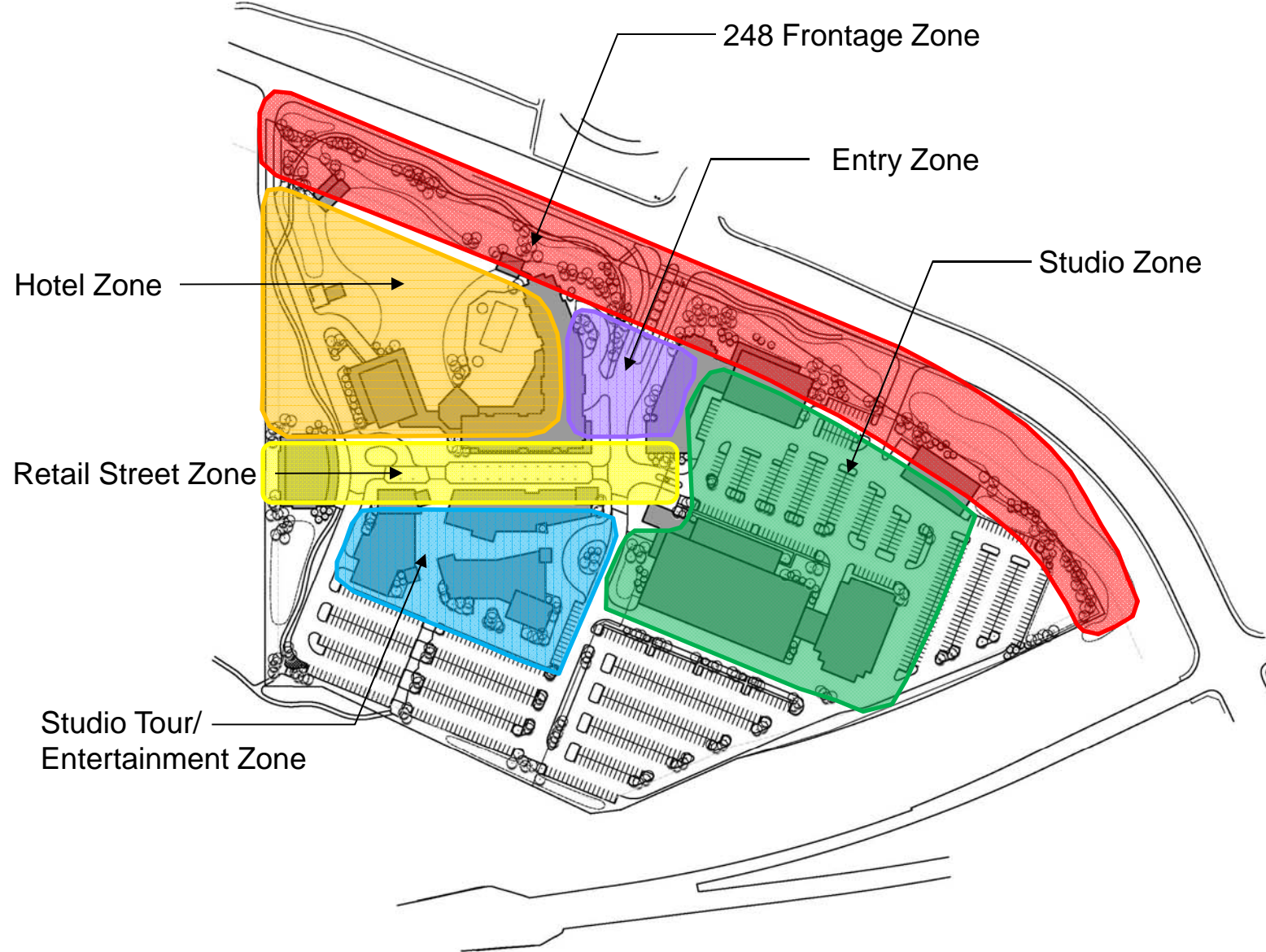

Raleigh Studios – Precedent Image Boards



SURROUNDING AREA BUILDINGS / ARCHITECTURE
PRECEDENT IMAGES

RALIEGH STUDIOS
March, 2012



Raleigh Studios
Park City, UT

Conceptual Site Plan
March 28, 2012

Raleigh Studios – Precedent Image Boards

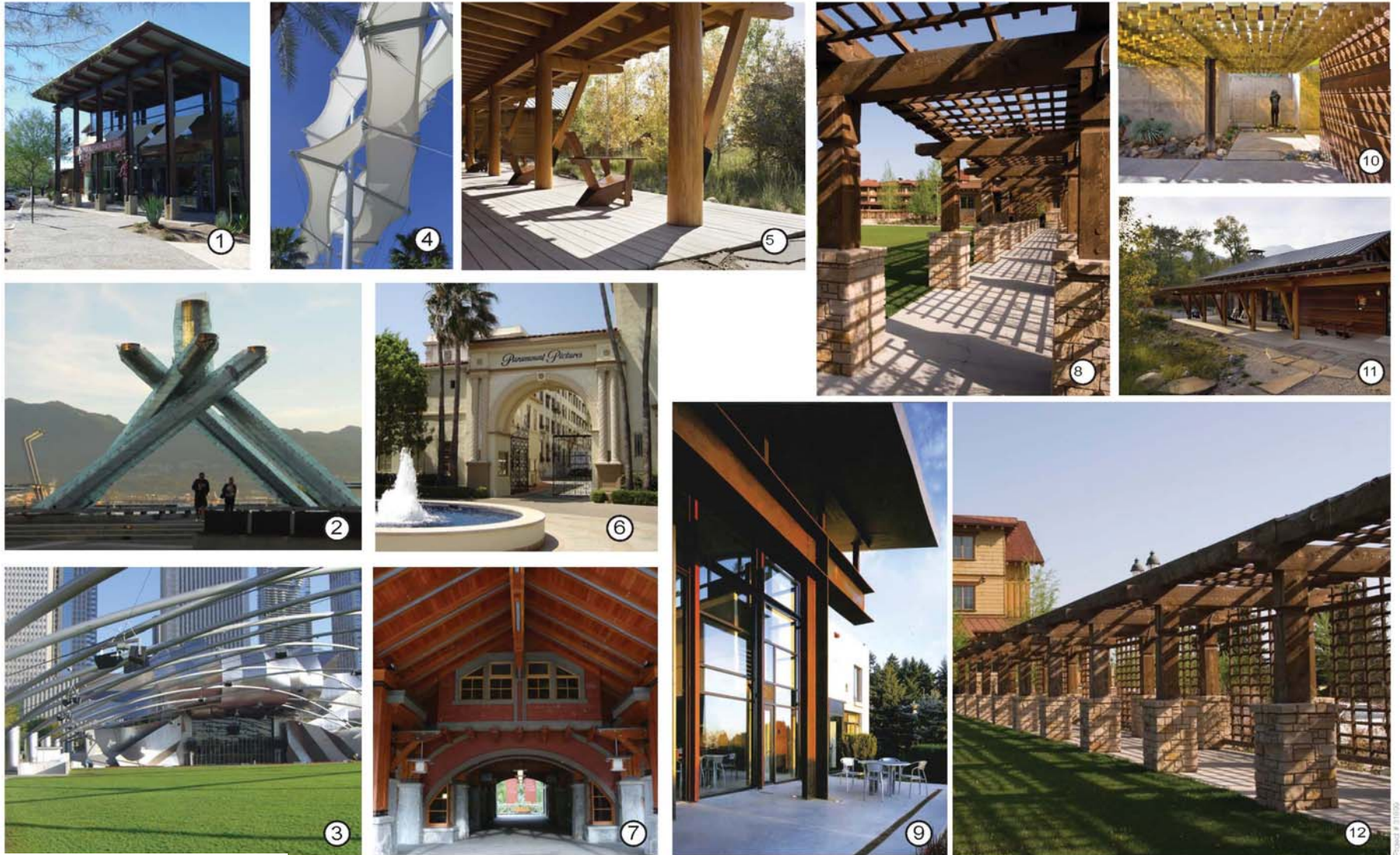

ENTRY / ARCHWAY CONCEPTS
PRECEDENT IMAGES

RALIEGH STUDIOS
March, 2012



Raleigh Studios
Park City, UT

Conceptual Site Plan
March 28, 2012

Raleigh Studios – Precedent Image Boards



ARCHITECTURAL CONCEPTS / MATERIALS
PRECEDENT IMAGES

RALIEGH STUDIOS
March, 2012



Raleigh Studios
Park City, UT

Conceptual Site Plan
March 28, 2012

Raleigh Studios – Precedent Image Boards



ARCHITECTURAL CONCEPTS / MATERIALS
PRECEDENT IMAGES

RALIEGH STUDIOS
March, 2012



Raleigh Studios
Park City, UT

Conceptual Site Plan
March 28, 2012

Raleigh Studios – Precedent Image Boards

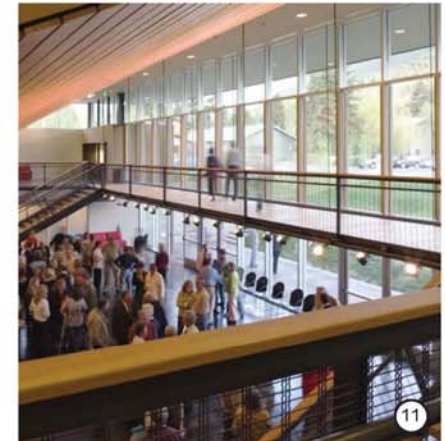
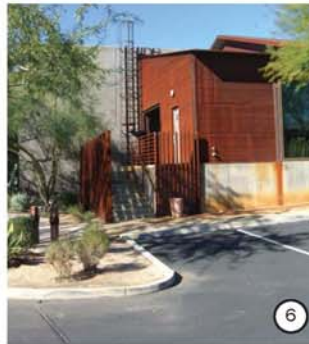

ARCHITECTURAL CONCEPTS / MATERIALS
PRECEDENT IMAGES

RALIEGH STUDIOS
March, 2012



Raleigh Studios
Park City, UT

Conceptual Site Plan
March 28, 2012

Previous Submittal Information – April 11, 2012



Raleigh Studios – Conceptual Site Plan Revisions

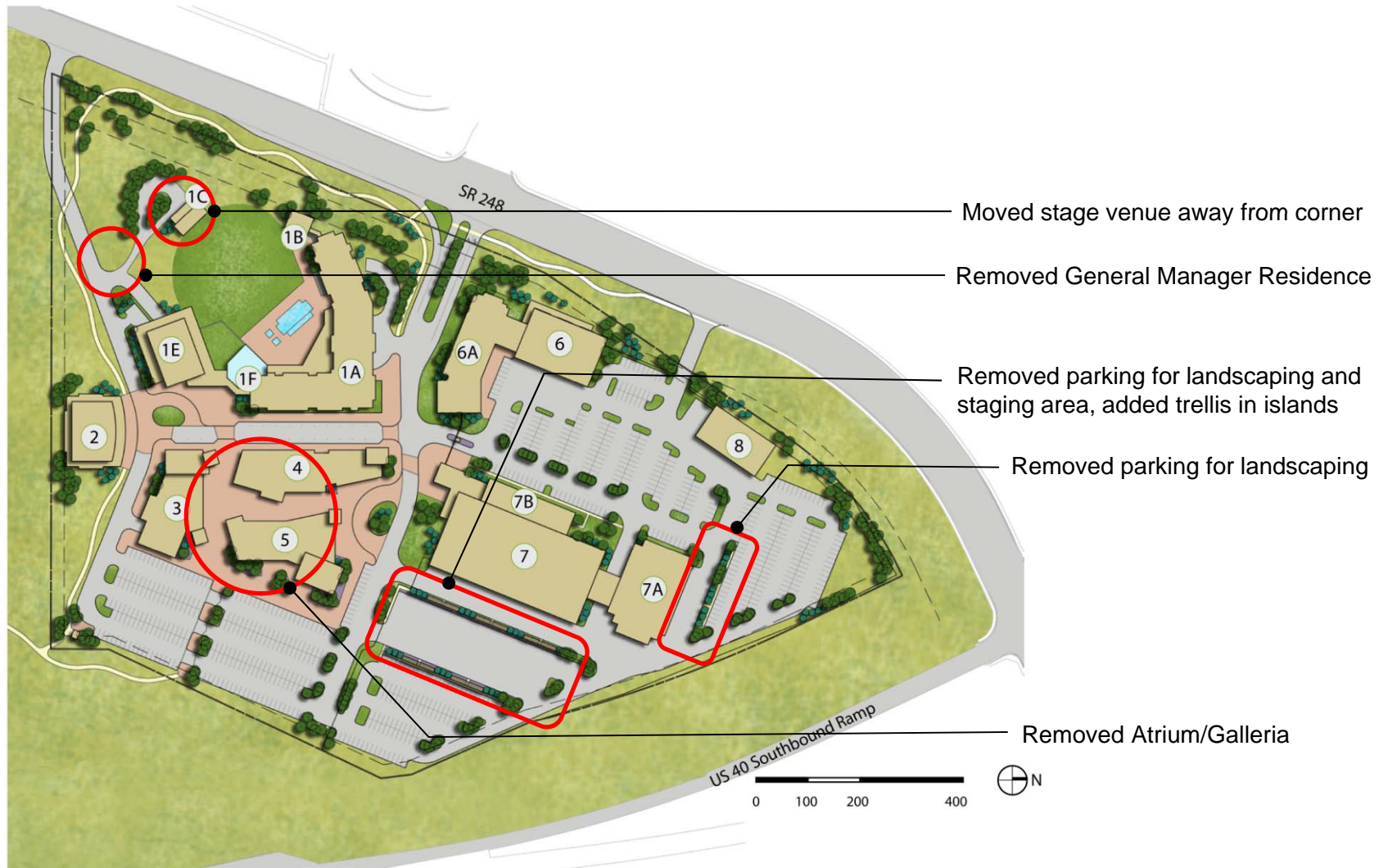

Raleigh Studios – Visual Analysis



View from US40 Northbound

Raleigh Studios – Visual Analysis



Massing Study Looking SE

Raleigh Studios – Visual Analysis



Buildings 7, 7A and 7B Massing Study Looking S

Raleigh Studios – Fencing Images

